



Deton

## MTK直联空调风机

前倾叶轮、双进风  
电机直联传动

**MTK Series**  
**DWDI, Forward Blades**  
**Direct Driven**  
**CENTRIFUGAL FAN**



广东肇庆德通有限公司  
GuangDong zhaoqing DETON Co., Ltd.  
March 2012

## 产品命名方式 Designation of Products

### MTK - 9-7 - D 6 3



## 产品特征 Technical specification

■ MTK系列空调风机采用前向多翼双进风叶轮，属于前倾空调风机公制中低压系列。

MTK series air condition fan adopts double suction forward curved impellers, belongs to metric and British system middle-low pressure forward air condition fan series.

■ 静音、省电、体积小、安装方便，可用于工矿企业、宾馆、大型商场等建筑物的通风换气；中央空调机组、空气净化设备、空调末端设备的配套。

Whist, energy-saving, little volume, convenient installation, can be used in workshop, plant, hotel, large market, building for ventilation, collocate using with Central air condition set, purify equipment, end of air conditioner etc.

■ 采用电机直联传动，可有效降低机械噪声，保证产品长期运作的稳定性能。单相电机具有调速功能，可满足应用场合对风机性能的多种需求。

Motor adopts direct driving, can reduce noise, to ensure steady long-term operating. The speed of single phase motor can be changed, so it can meet many different requirements of customers.

■ 叶轮经过严格的动平衡，平衡精度为G4.0级。

Impeller adopts forward curved multi-blades, balance precision is G4.0

■ 风机所有部件均采用镀锌板制作，具有一定的防腐蚀能力。

All parts use galvanized steel as material, it's anticorrosive.

■ 风机运行时严禁风口全开使用，否则会因超载而导致电机损坏。

Prohibit to fully open inlet when operating, to avoid motor damage caused by overload.

■ 使用环境要求：输送气体介质为无腐蚀性、不易燃易爆、含固体颗粒不大于100mg/m<sup>3</sup>，介质温度在-10℃~40℃。

It operated in environment with on inflammable, explosive, erosive air, solid grain contained below 100mg/m<sup>3</sup>, and air temperature is between -10℃~40℃.

MTK系列风机性能参数未经AMCA认证。

Performance of MTK Fans are not licensed by AMCA International.

# MTK7-7-D43

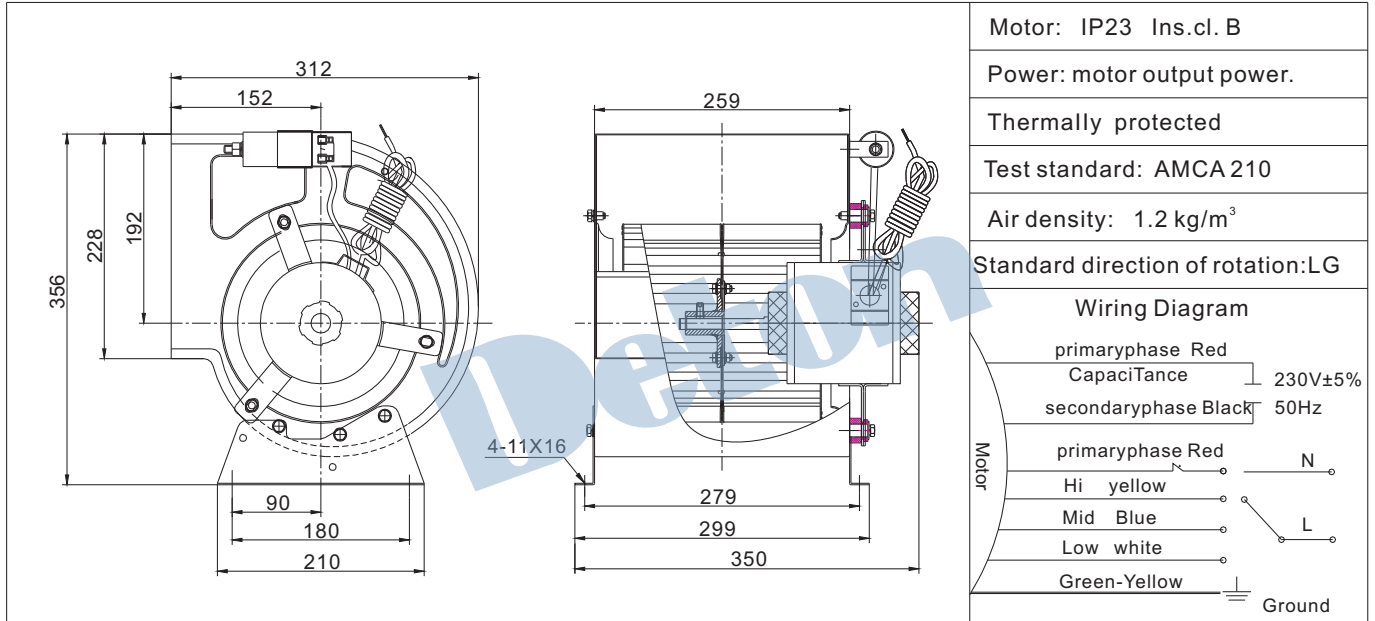

Motor: IP23 Ins.cl. B  
 Power: motor output power.  
 Thermally protected  
 Test standard: AMCA 210  
 Air density: 1.2 kg/m<sup>3</sup>  
 Standard direction of rotation: LG

**Wiring Diagram**

primaryphase Red  
 Capacitance 230V±5%  
 secondaryphase Black 50Hz

Motor

primaryphase Red N  
 Hi yellow L  
 Mid Blue  
 Low white  
 Green-Yellow Ground

Hi. speed 高速档	Speed 转速	1370 r/min	Power 功率	280 W	Amp. 电流	2.0 A
Mid. speed 中速档	Speed 转速	1260 r/min	Power 功率	200 W	Amp. 电流	1.7 A
Low speed 低速档	Speed 转速	1160 r/min	Power 功率	160 W	Amp. 电流	1.4 A
Capacitor 电容		12μF / 450V		Voltage 电压	230V±5% / 50Hz	
				Weight 重量	9 kg	

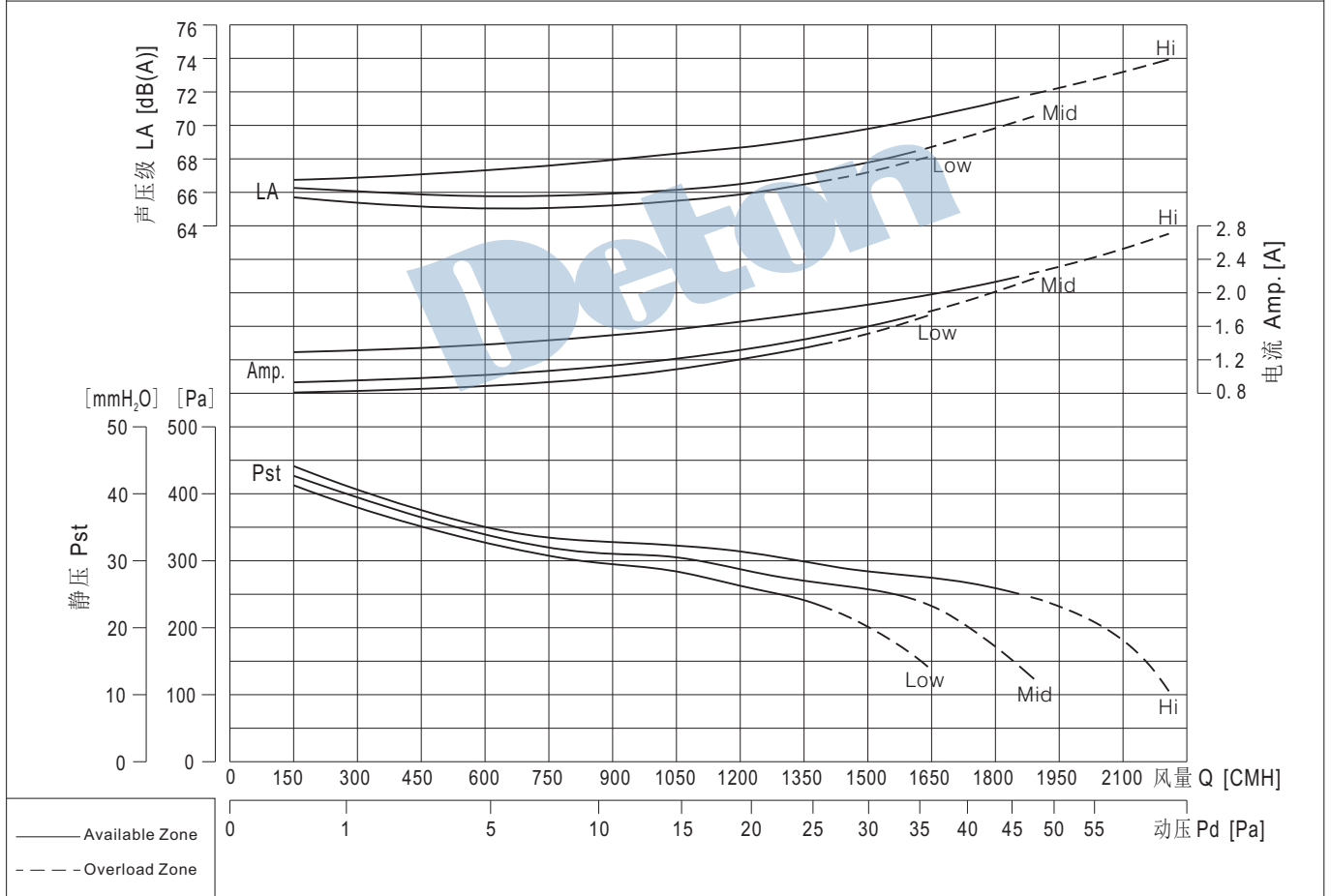

### MTK7-7-D61

Motor: IP23 Ins.cl. B

Power: motor output power.

Thermally protected

Test standard: AMCA 210

Air density: 1.2 kg/m<sup>3</sup>

Standard direction of rotation: LG

**Wiring Diagram**

primaryphase Blue — 230V±5%

Capacitance — 50Hz

secondaryphase Black —

primaryphase Brown — N

Blue — L

Green-Yellow — Ground

Speed 转速	880 r/min	Power 功率	130 W	Amp. 电流	1.1 A
-------------	-----------	-------------	-------	------------	-------

Capacitor 电容	5μF /450V	Voltage 电压	230V±5% / 50Hz	Weight 重量	9 kg
-----------------	-----------	---------------	----------------	--------------	------

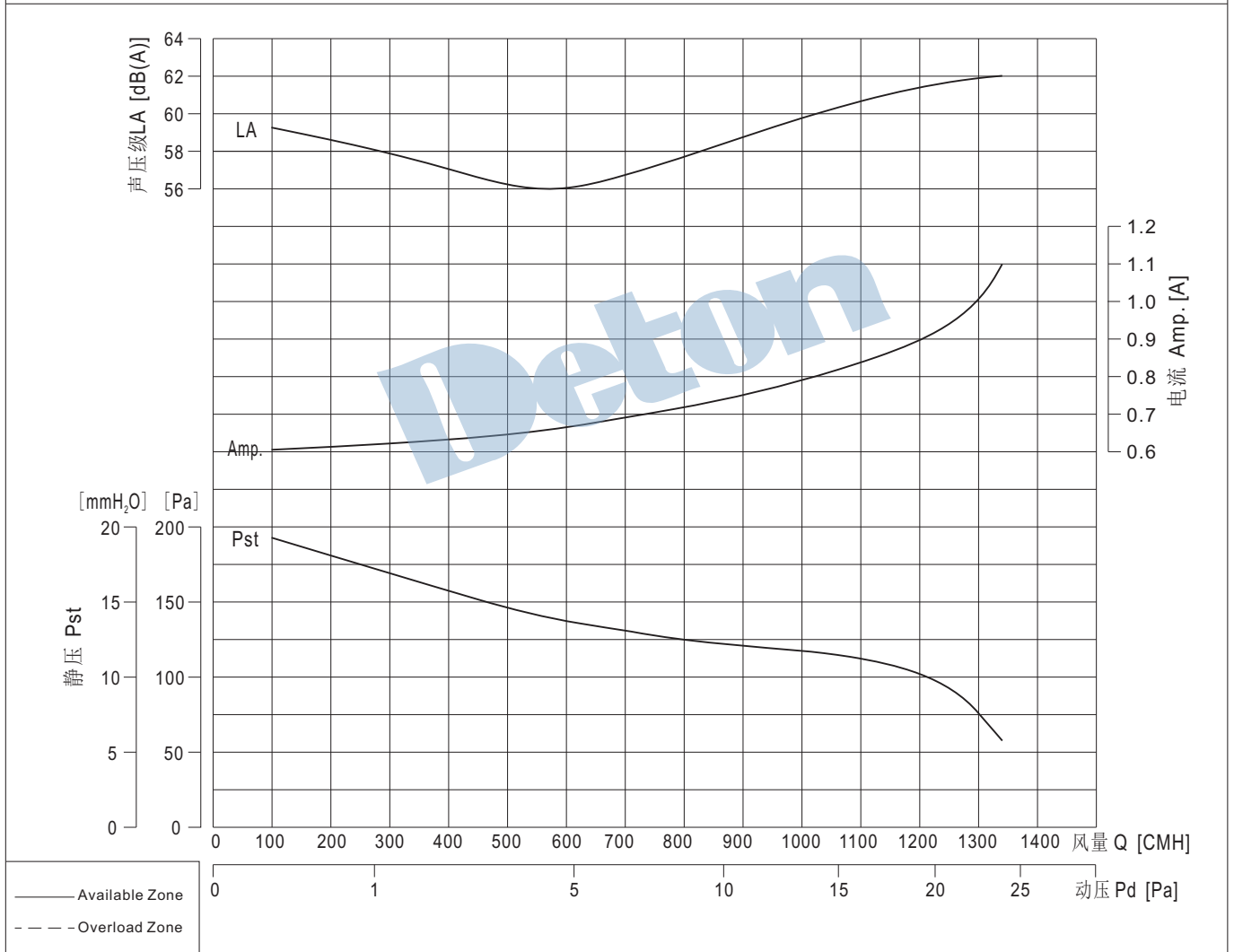

# MTK7-7-S41

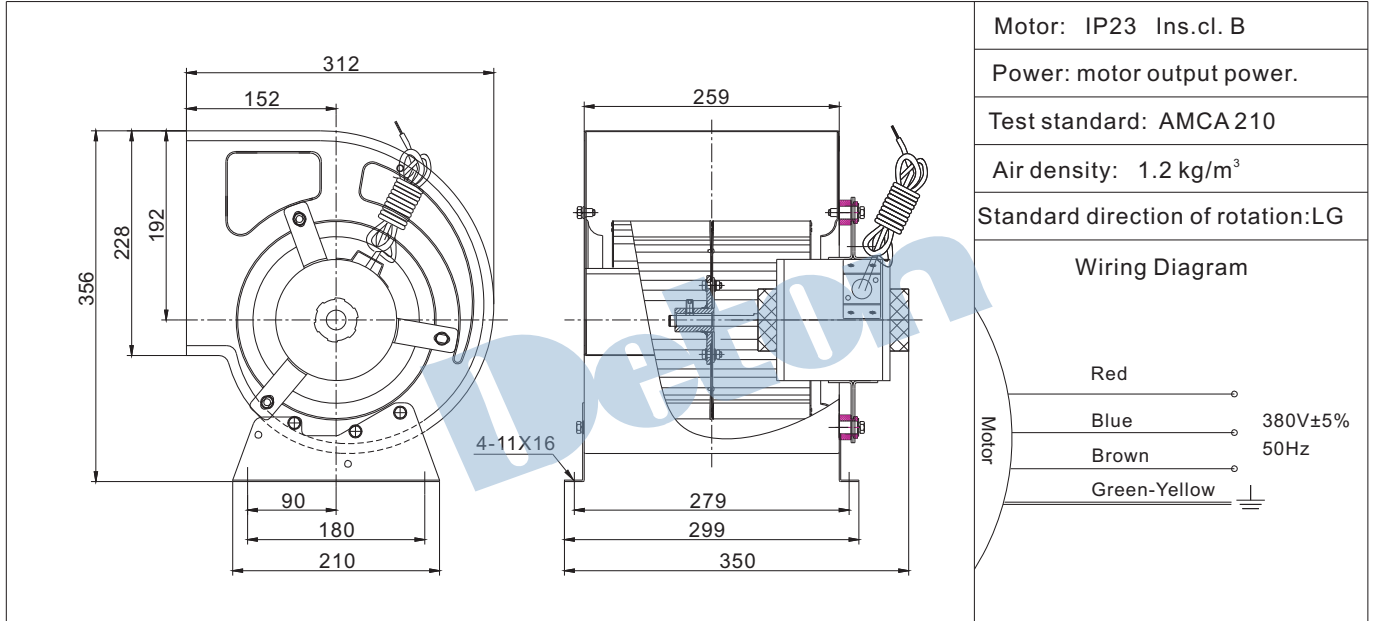

Speed 转速	1330 r/min	Power 功率	330 W	Amp. 电流	1.1 A
-------------	------------	-------------	-------	------------	-------

Voltage 电压	380V±5% / 50Hz	Weight 重量	8.5 kg
---------------	----------------	--------------	--------

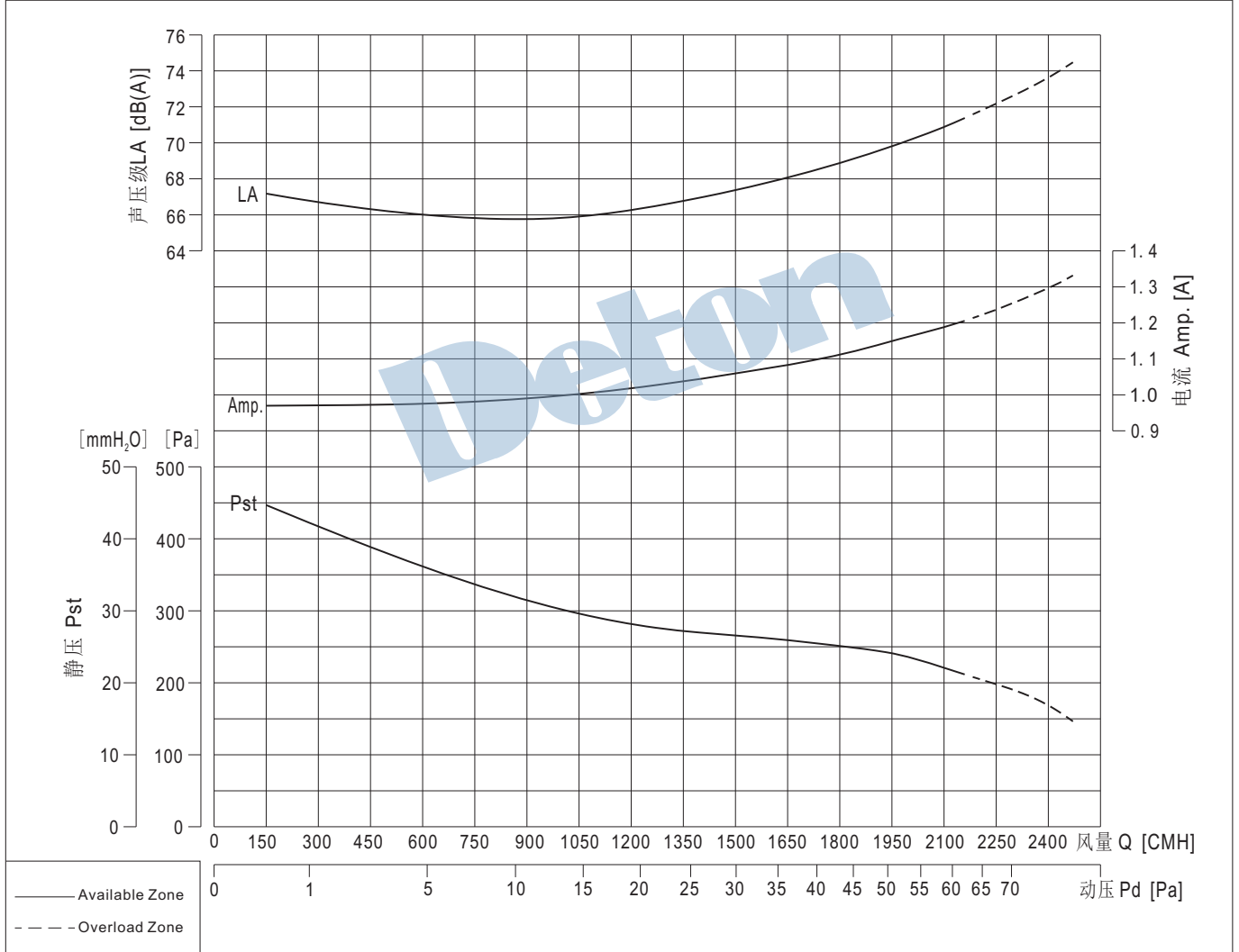

MTK Series

### MTK7-7-S61

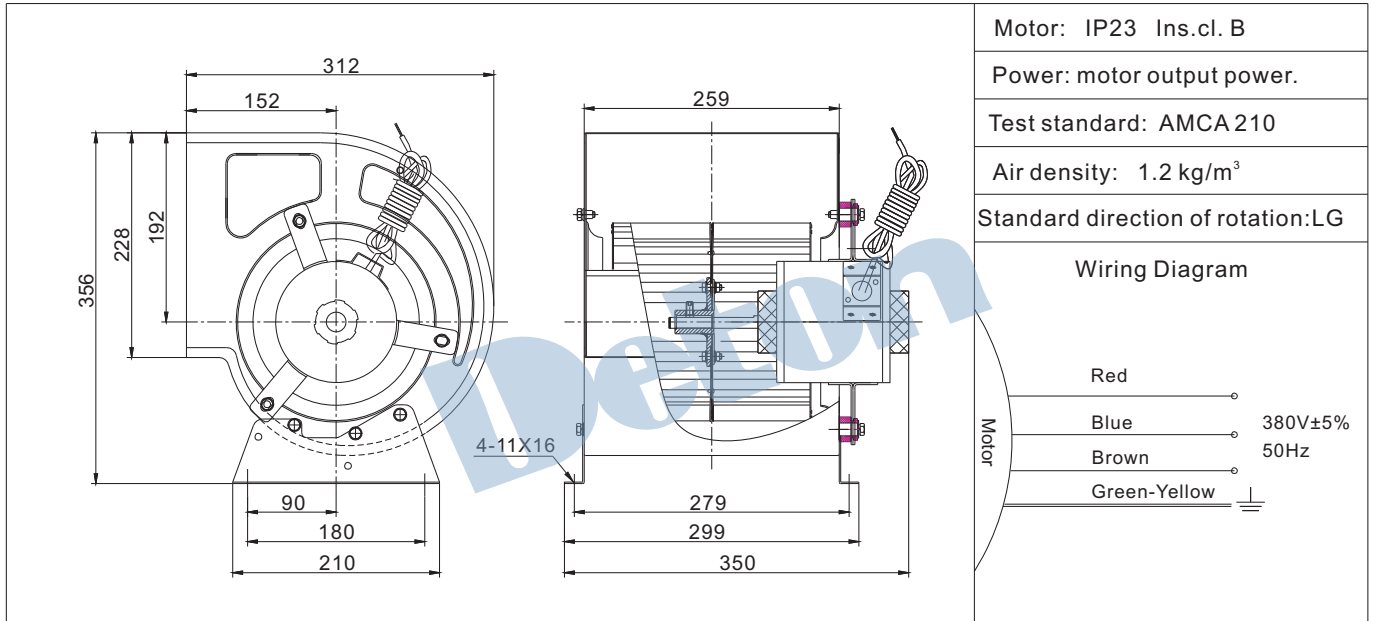

Speed 转速	900 r/min	Power 功率	130 W	Amp. 电流	0.6 A
-------------	-----------	-------------	-------	------------	-------

Voltage 电压	380V±5% / 50Hz	Weight 重量	8.5 kg
---------------	----------------	--------------	--------

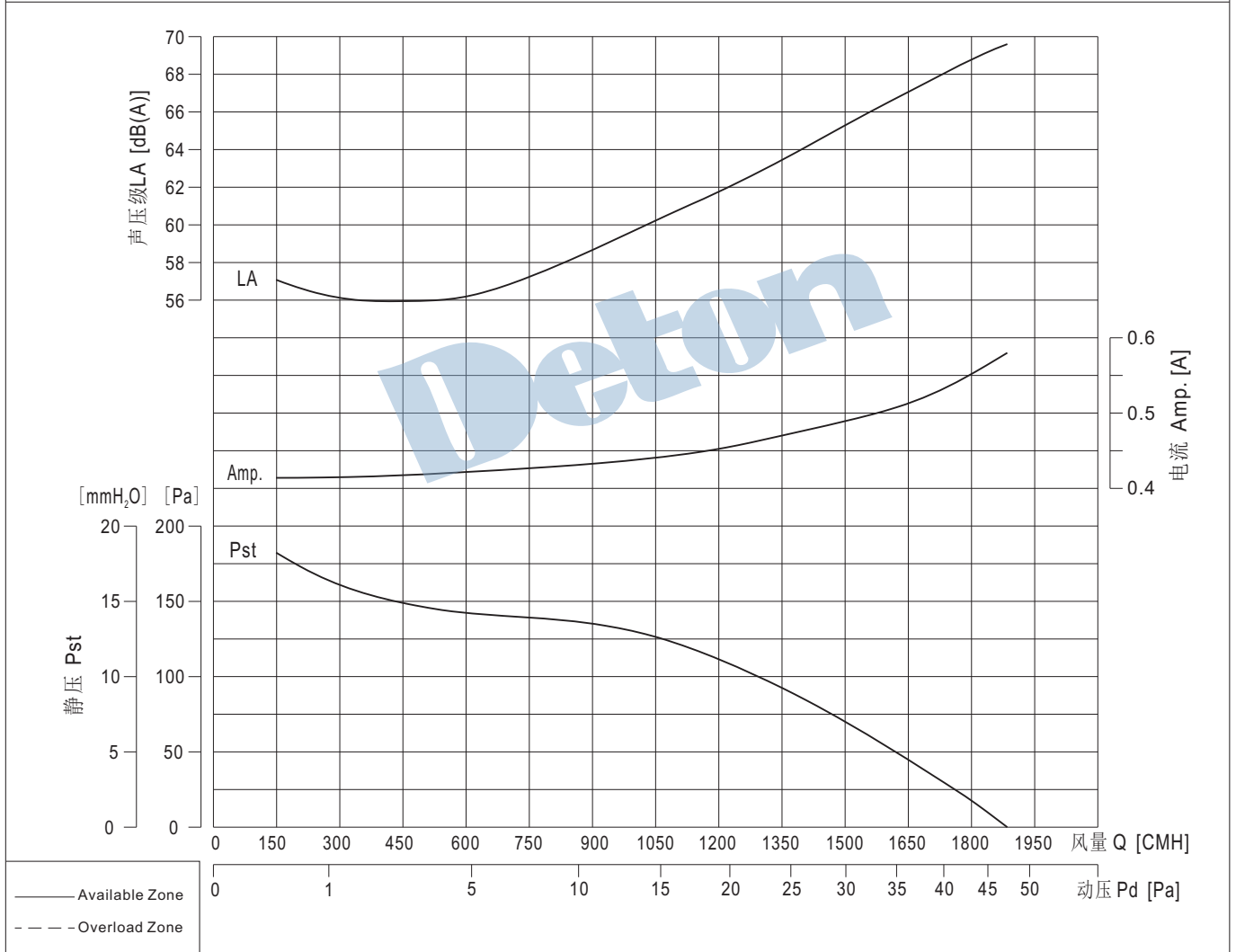

# MTK8-8-D43

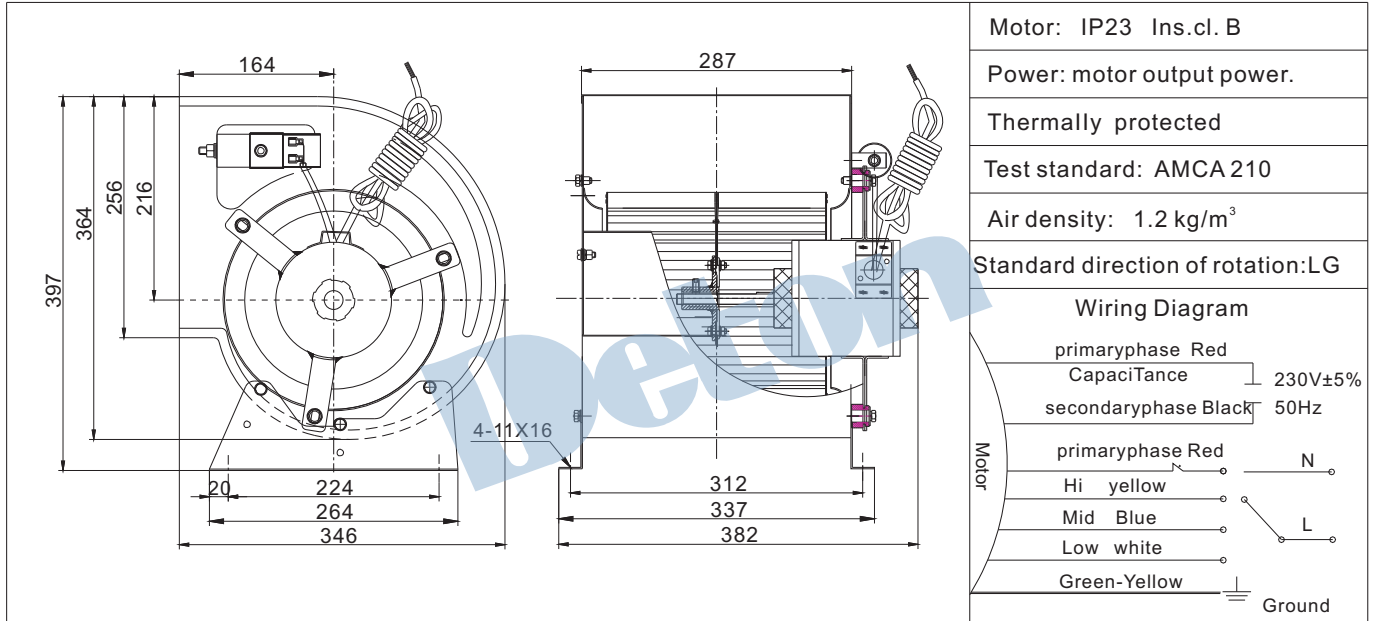

Hi. speed 高速档	Speed 转速	1350 r/min	Power 功率	300 W	Amp. 电流	2.8 A
Mid. speed 中速档	Speed 转速	1260 r/min	Power 功率	220 W	Amp. 电流	2.0 A
Low speed 低速档	Speed 转速	1080 r/min	Power 功率	180 W	Amp. 电流	1.7 A

Capacitor 电容	12μF / 450V	Voltage 电压	230V±5% / 50Hz	Weight 重量	12.5 kg
-----------------	-------------	---------------	----------------	--------------	---------

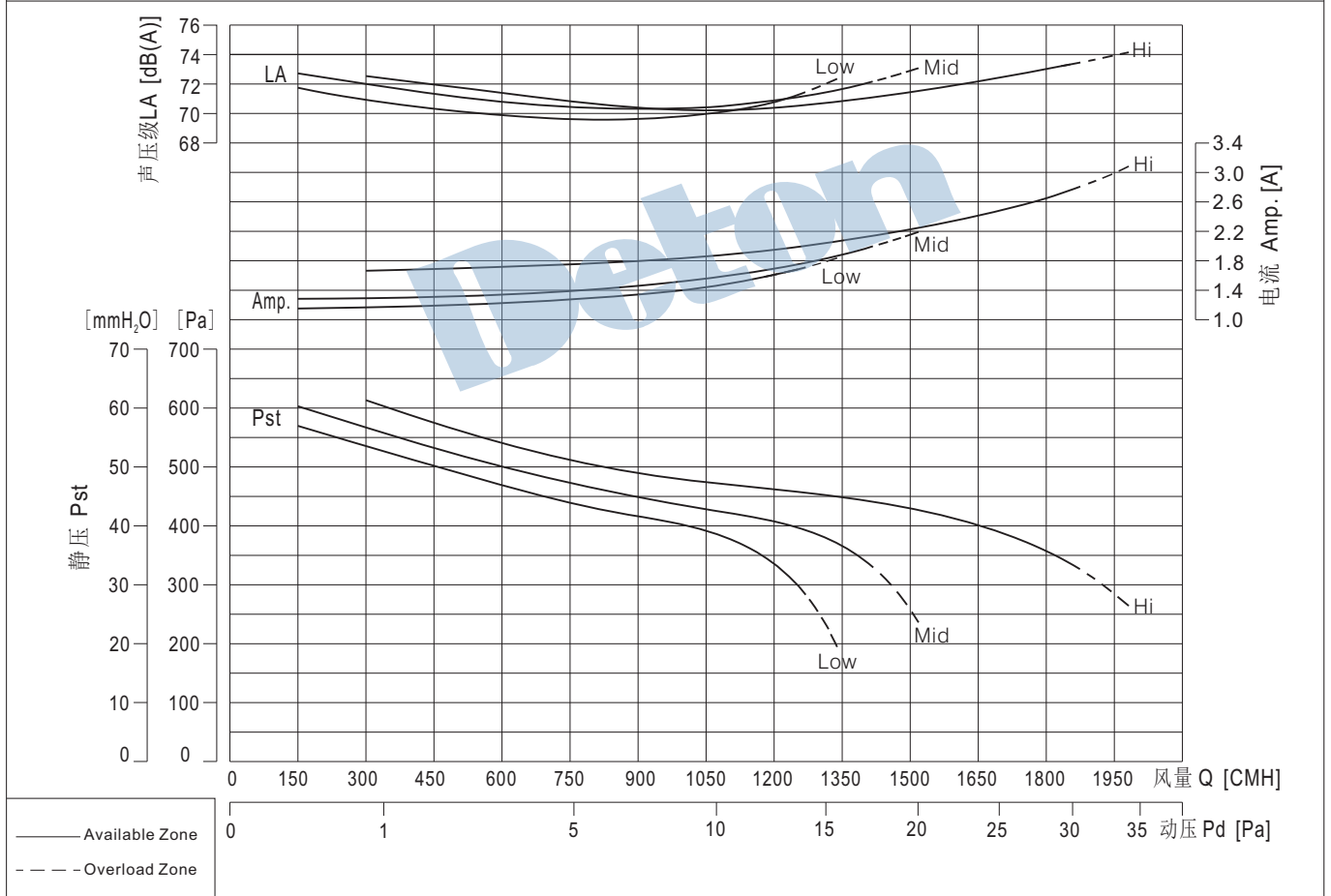

### MTK8-8-D61

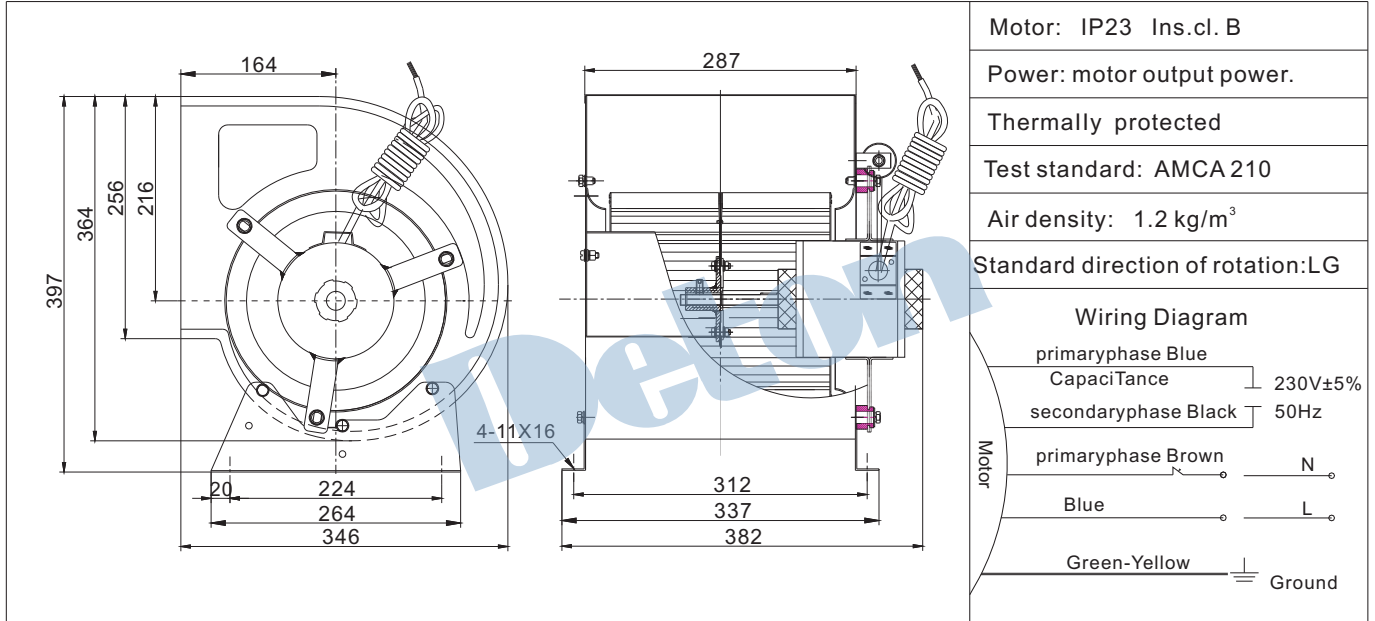

Speed 转速	900 r/min	Power 功率	150 W	Amp. 电流	1.45 A
Capacitor 电容	7μF /450V	Voltage 电压	230V±5% / 50Hz	Weight 重量	12.5 kg

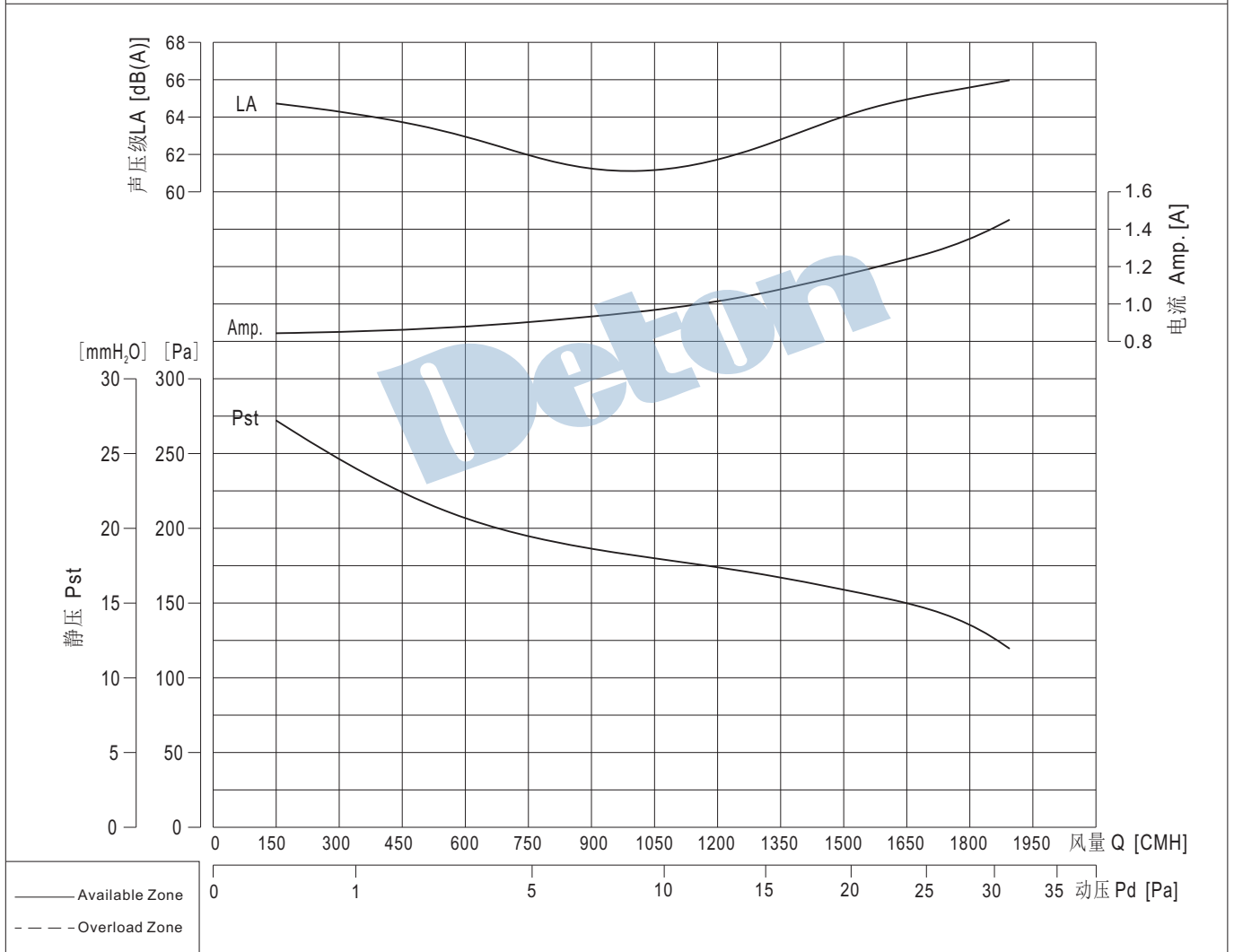



# MTK8-8-S41

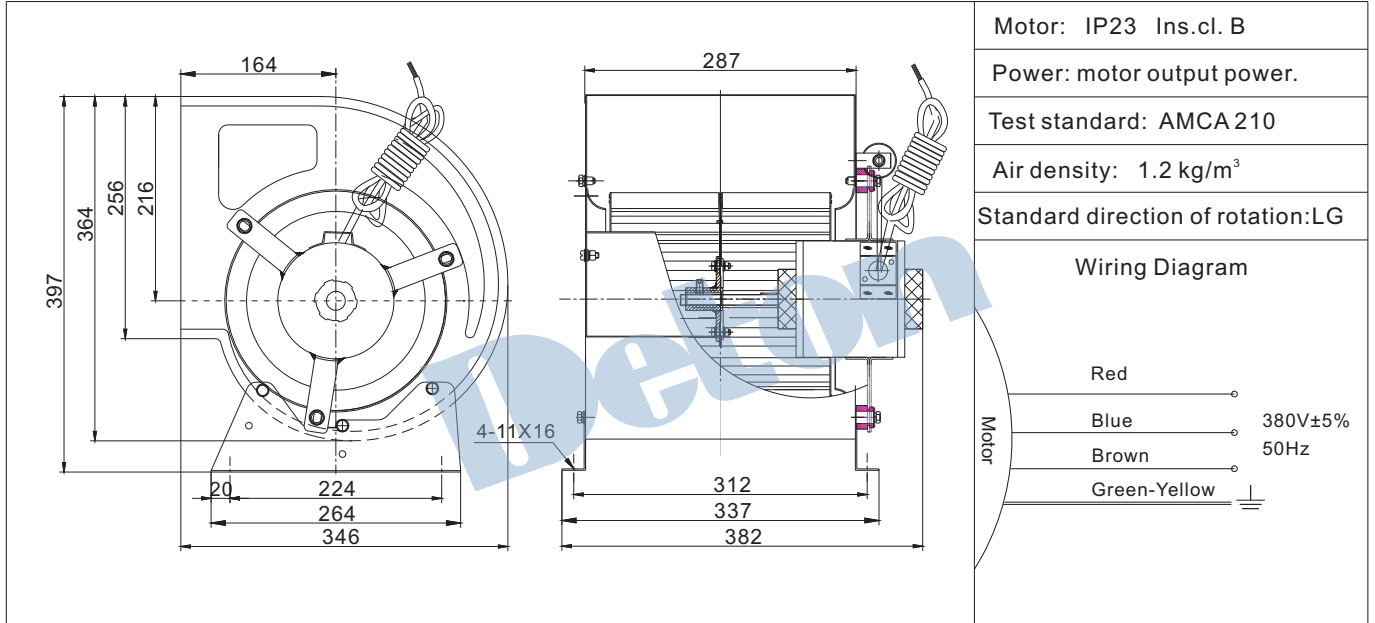

Speed 转速	1340 r/min	Power 功率	350 W	Amp. 电流	1.6 A
-------------	------------	-------------	-------	------------	-------

Voltage 电压	380V±5% / 50Hz	Weight 重量	12 kg
---------------	----------------	--------------	-------

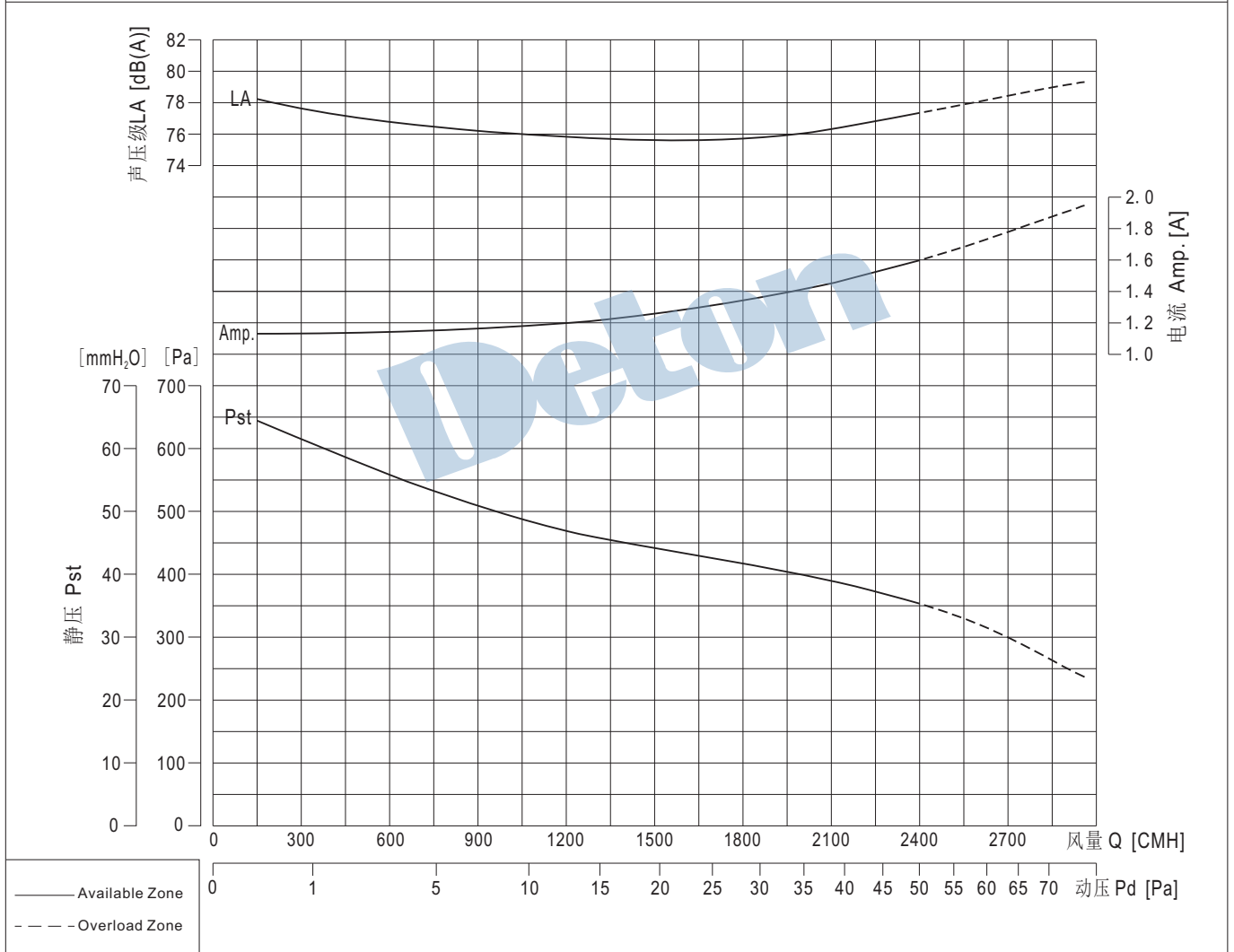

### MTK8-8-S61

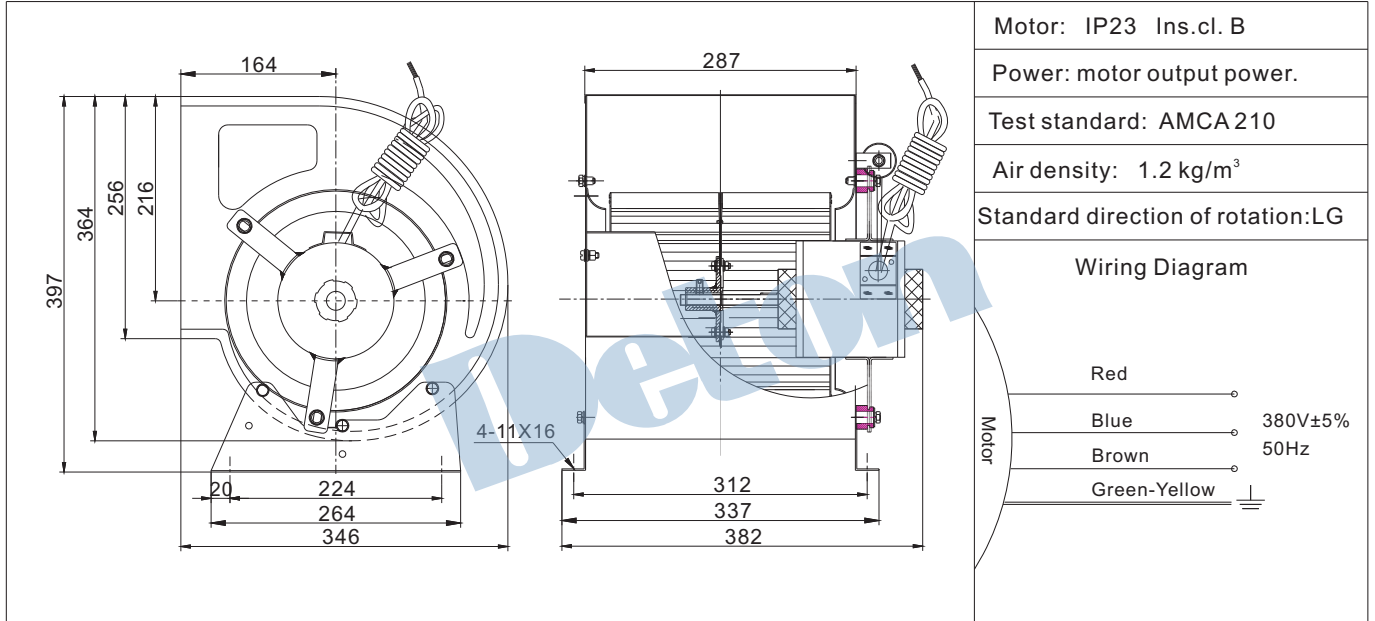

Speed 转速	900 r/min	Power 功率	150 W	Amp. 电流	0.63 A
-------------	-----------	-------------	-------	------------	--------

Voltage 电压	380V±5% / 50Hz	Weight 重量	12 kg
---------------	----------------	--------------	-------

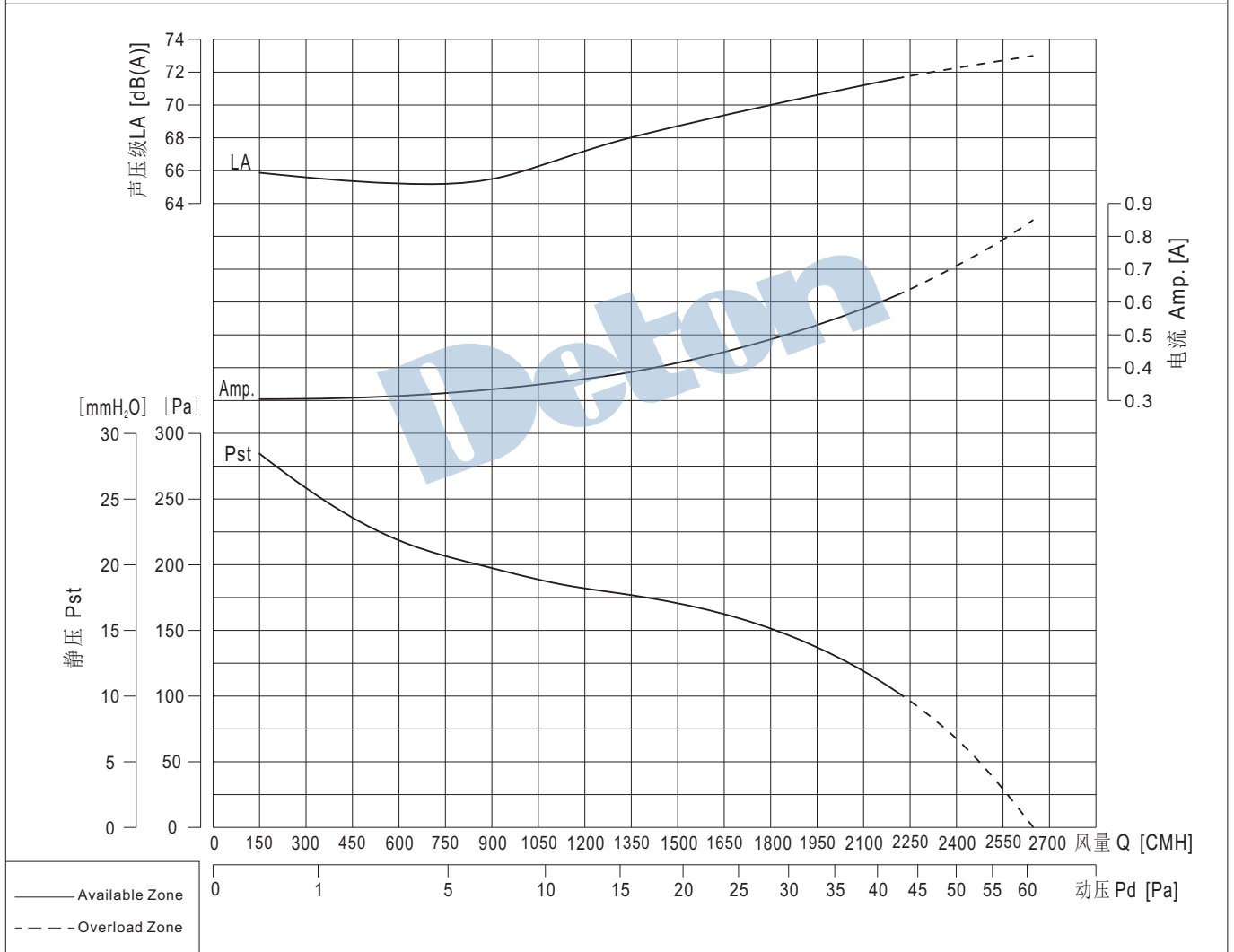

### MTK9-7-D43

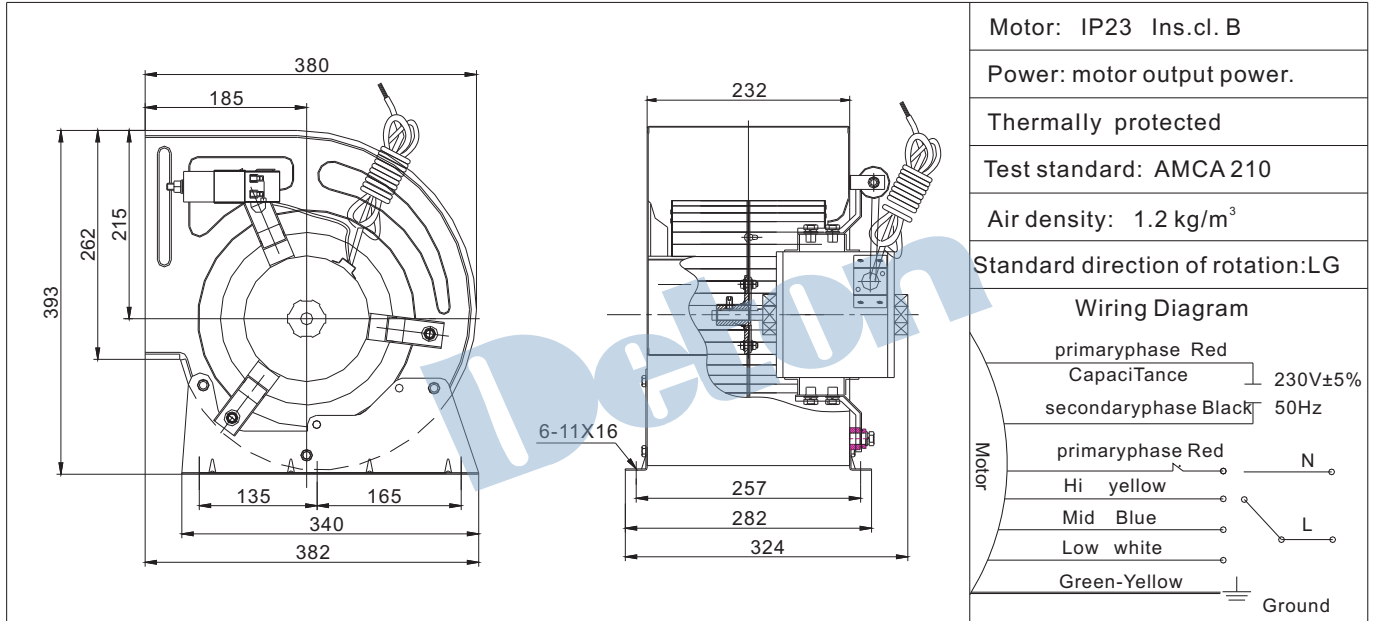

Motor: IP23 Ins.cl. B
Power: motor output power.
Thermally protected
Test standard: AMCA 210
Air density: 1.2 kg/m <sup>3</sup>
Standard direction of rotation: LG
<b>Wiring Diagram</b> primaryphase Red Capacitance 230V±5% secondaryphase Black 50Hz primaryphase Red N Hi yellow L Mid Blue Low white Green-Yellow Ground

Hi. speed 高速档	Speed 转速	1330 r/min	Power 功率	380 W	Amp. 电流	3.2A
Mid. speed 中速档	Speed 转速	1260 r/min	Power 功率	300 W	Amp. 电流	2.2 A
Low speed 低速档	Speed 转速	1080 r/min	Power 功率	220 W	Amp. 电流	1.9 A

Capacitor 电容	12μF /450V	Voltage 电压	230V±5% / 50Hz	Weight 重量	14.5 kg
-----------------	------------	---------------	----------------	--------------	---------

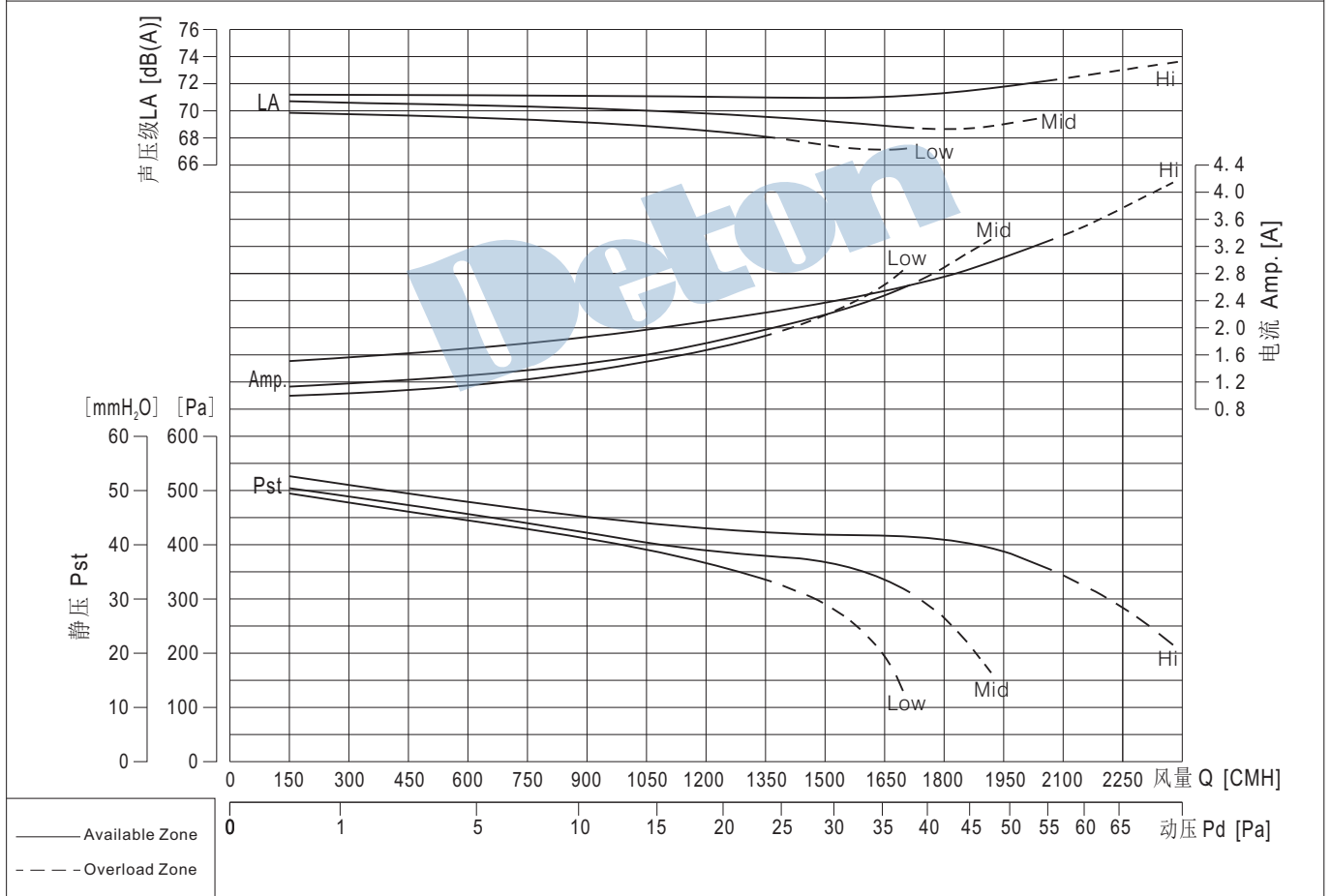

### MTK9-7-D63

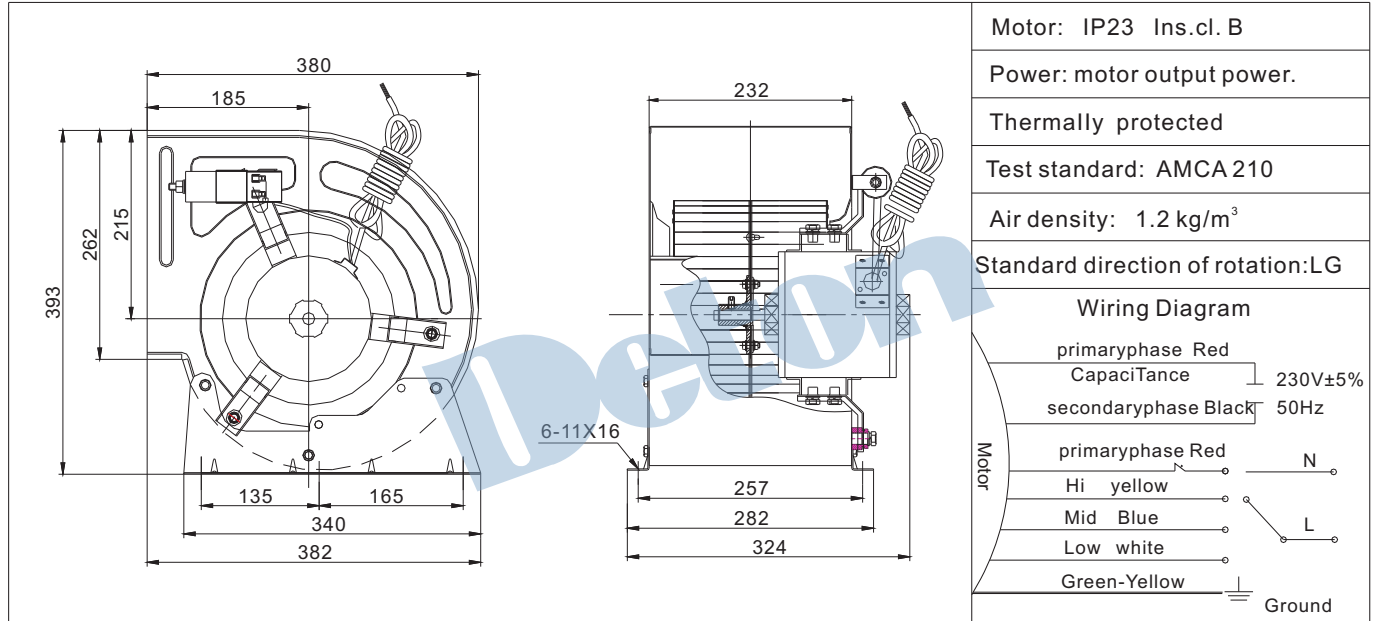

Hi. speed 高速档	Speed 转速	890 r/min	Power 功率	180 W	Amp. 电流	1.9 A	
Mid. speed 中速档	Speed 转速	830 r/min	Power 功率	130 W	Amp. 电流	1.3 A	
Low speed 低速档	Speed 转速	770 r/min	Power 功率	120 W	Amp. 电流	1.2 A	
Capacitor 电容		10 $\mu$ F / 450V	Voltage 电压		230V $\pm$ 5% / 50Hz	Weight 重量	14.5 kg

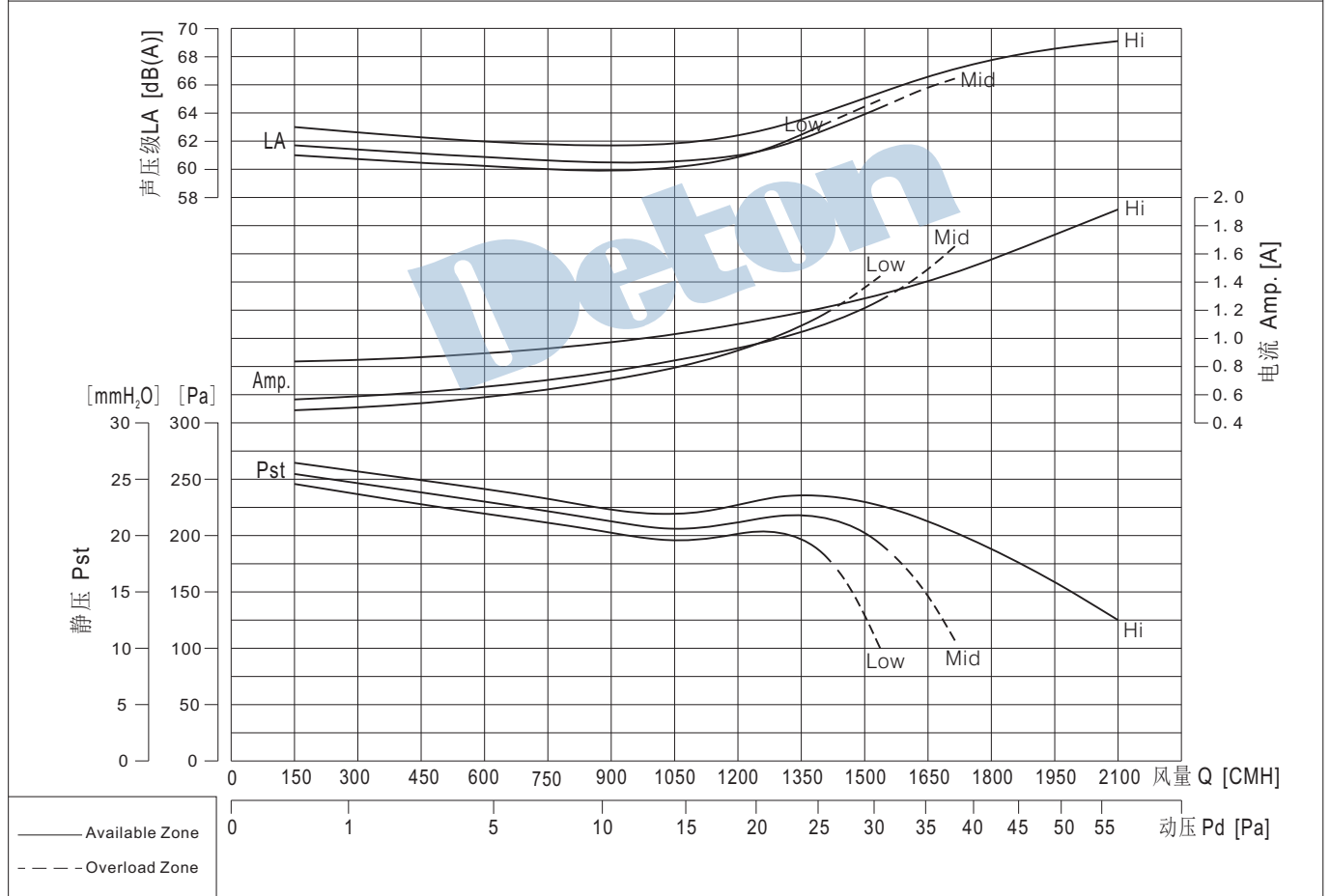

# MTK9-7-S41

Motor: IP23 Ins.cl. B

Power: motor output power.

Test standard: AMCA 210

Air density: 1.2 kg/m<sup>3</sup>

Standard direction of rotation: LG

Wiring Diagram

<b>Speed</b> 转速	1350 r/min	<b>Power</b> 功率	380 W	<b>Amp.</b> 电流	1.6 A
--------------------	------------	--------------------	-------	-------------------	-------

<b>Voltage</b> 电压	380V±5% / 50Hz	<b>Weight</b> 重量	14.5 kg
----------------------	----------------	---------------------	---------

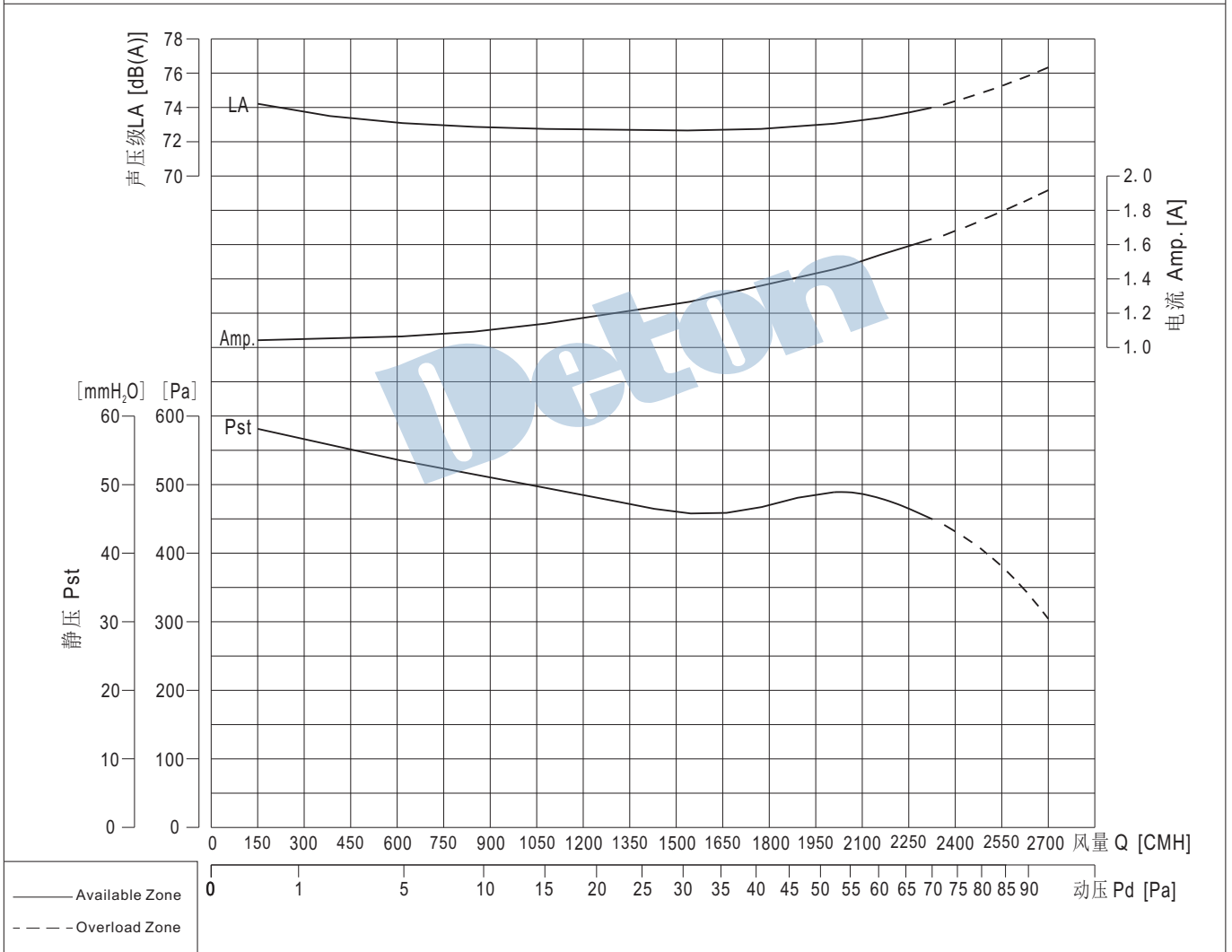

### MTK9-7-S61

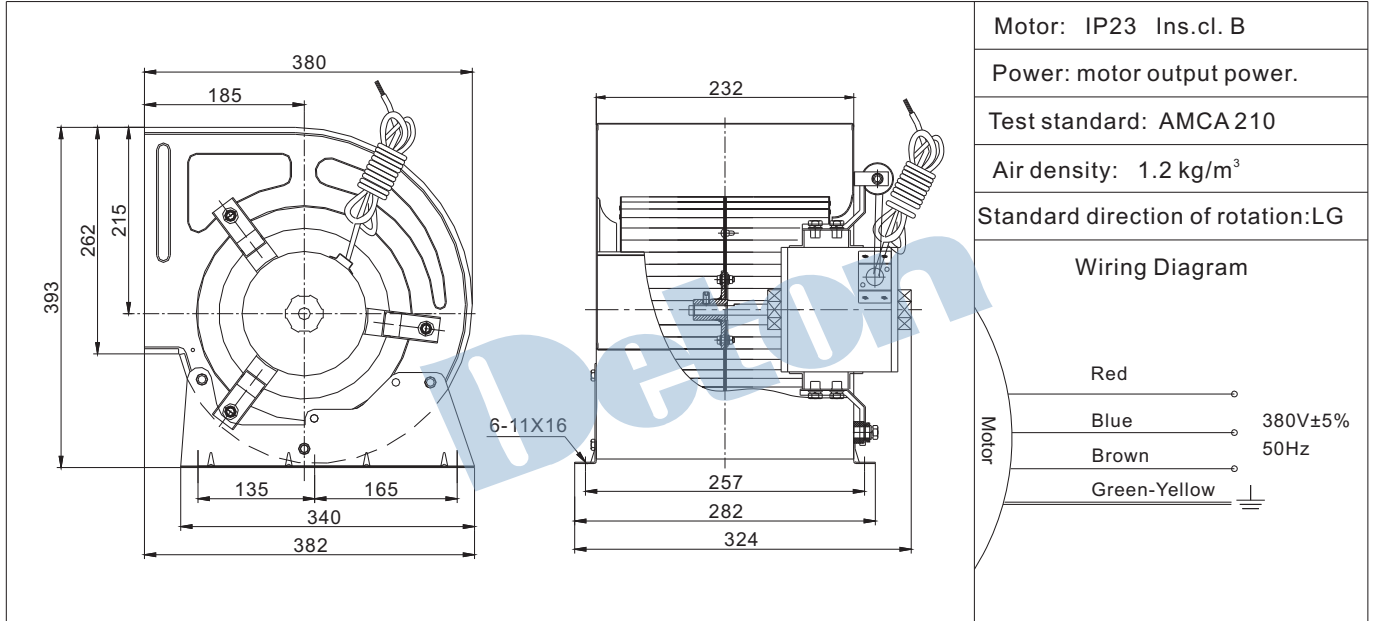

Speed 转速	880 r/min	Power 功率	200 W	Amp. 电流	0.9 A
-------------	-----------	-------------	-------	------------	-------

Voltage 电压	380V±5% / 50Hz	Weight 重量	14.5 kg
---------------	----------------	--------------	---------

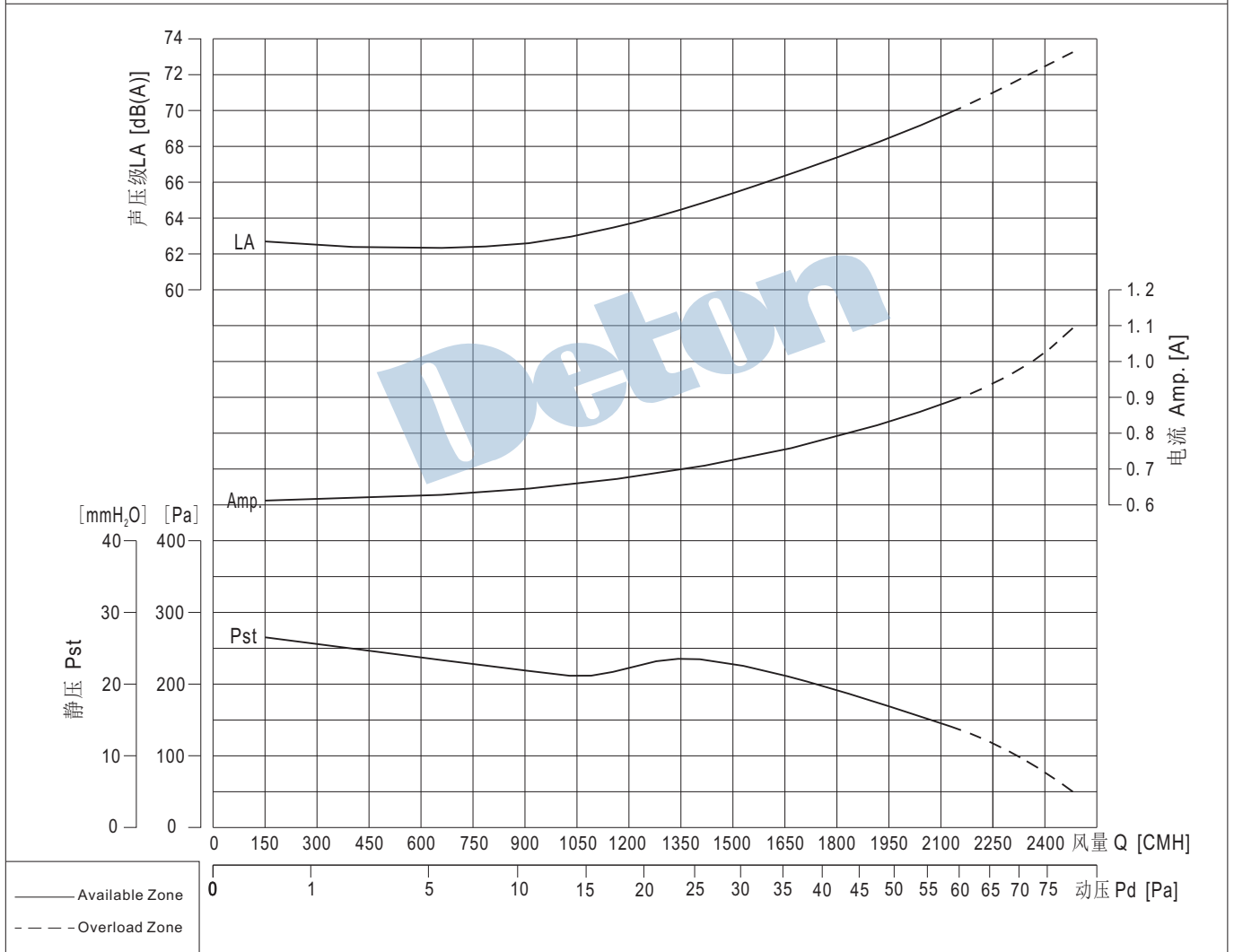

### MTK9-9-D43

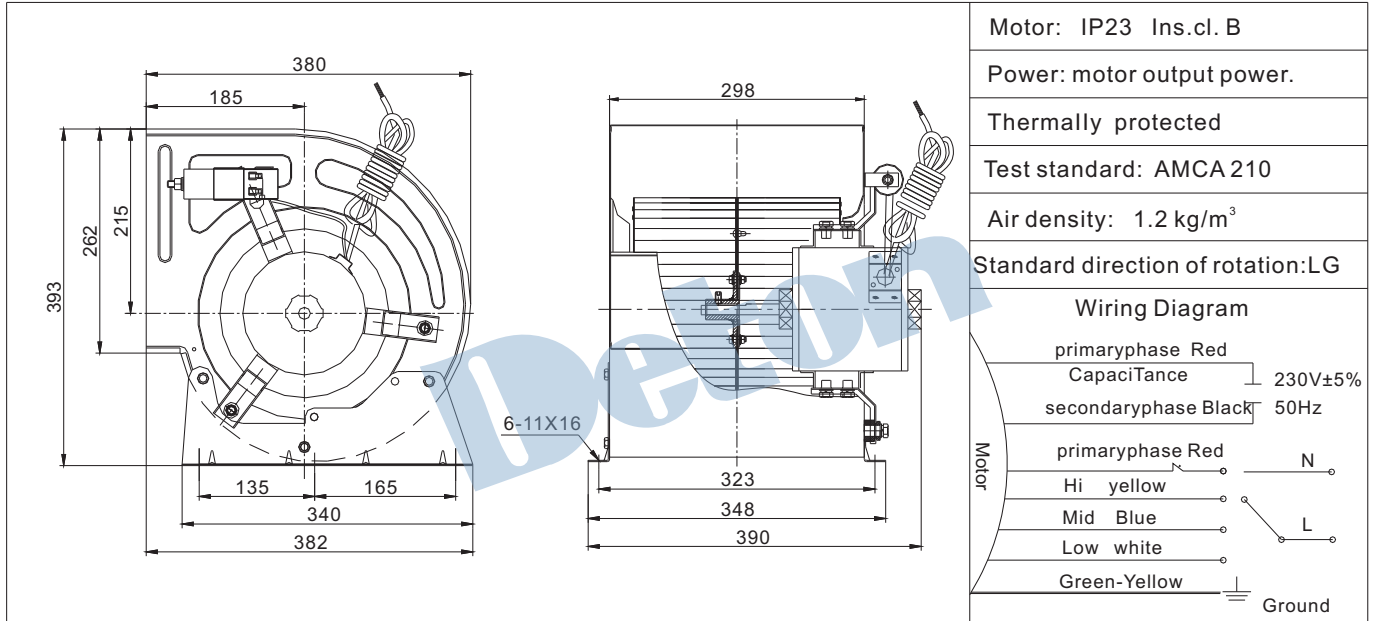

Hi. speed 高速档	Speed 转速	1360 r/min	Power 功率	550 W	Amp. 电流	4.5 A
Mid. speed 中速档	Speed 转速	1260 r/min	Power 功率	380 W	Amp. 电流	3.0 A
Low speed 低速档	Speed 转速	1180 r/min	Power 功率	260 W	Amp. 电流	2.5 A

Capacitor 电容	16 $\mu$ F / 450V	Voltage 电压	230V $\pm$ 5% / 50Hz	Weight 重量	16.5 kg
-----------------	-------------------	---------------	----------------------	--------------	---------

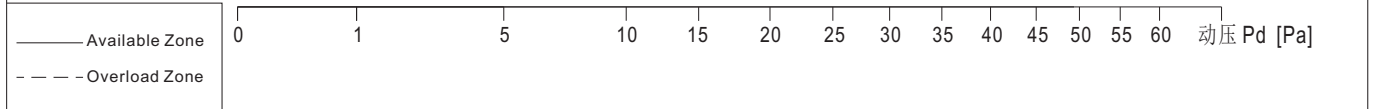
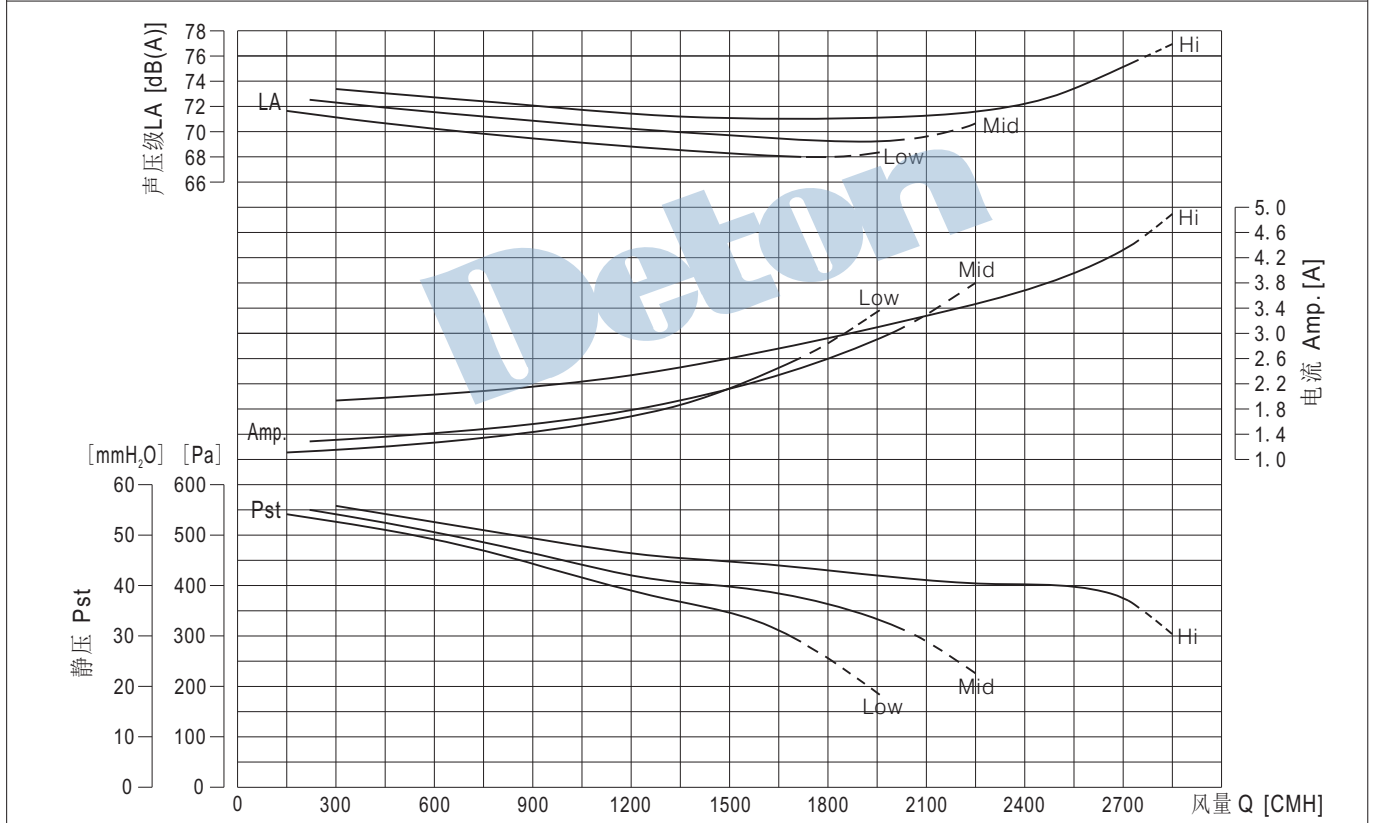

MTK Series

## MTK9-9-D63

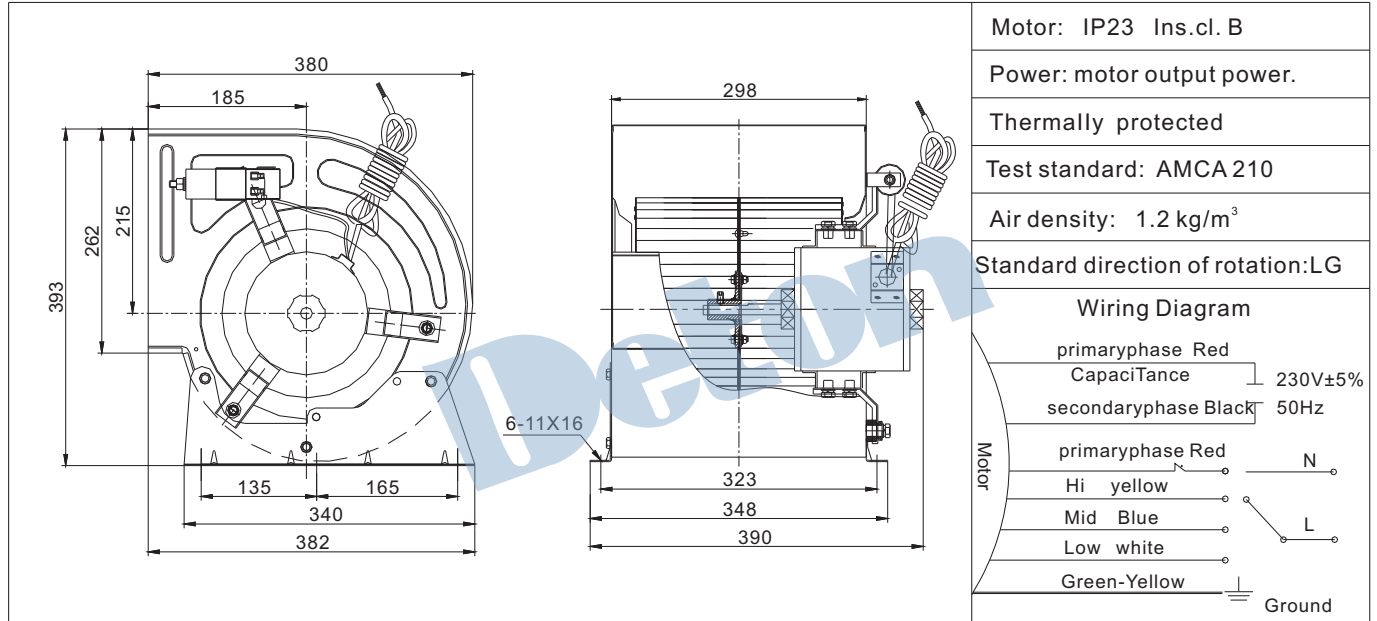

Hi. speed 高速档	Speed 转速	890 r/min	Power 功率	200 W	Amp. 电流	2.2 A	
Mid. speed 中速档	Speed 转速	810 r/min	Power 功率	150 W	Amp. 电流	1.6 A	
Low speed 低速档	Speed 转速	750 r/min	Power 功率	130 W	Amp. 电流	1.3 A	
Capacitor 电容		10 $\mu$ F / 450V	Voltage 电压		230V $\pm$ 5% / 50Hz	Weight 重量	16.5 kg

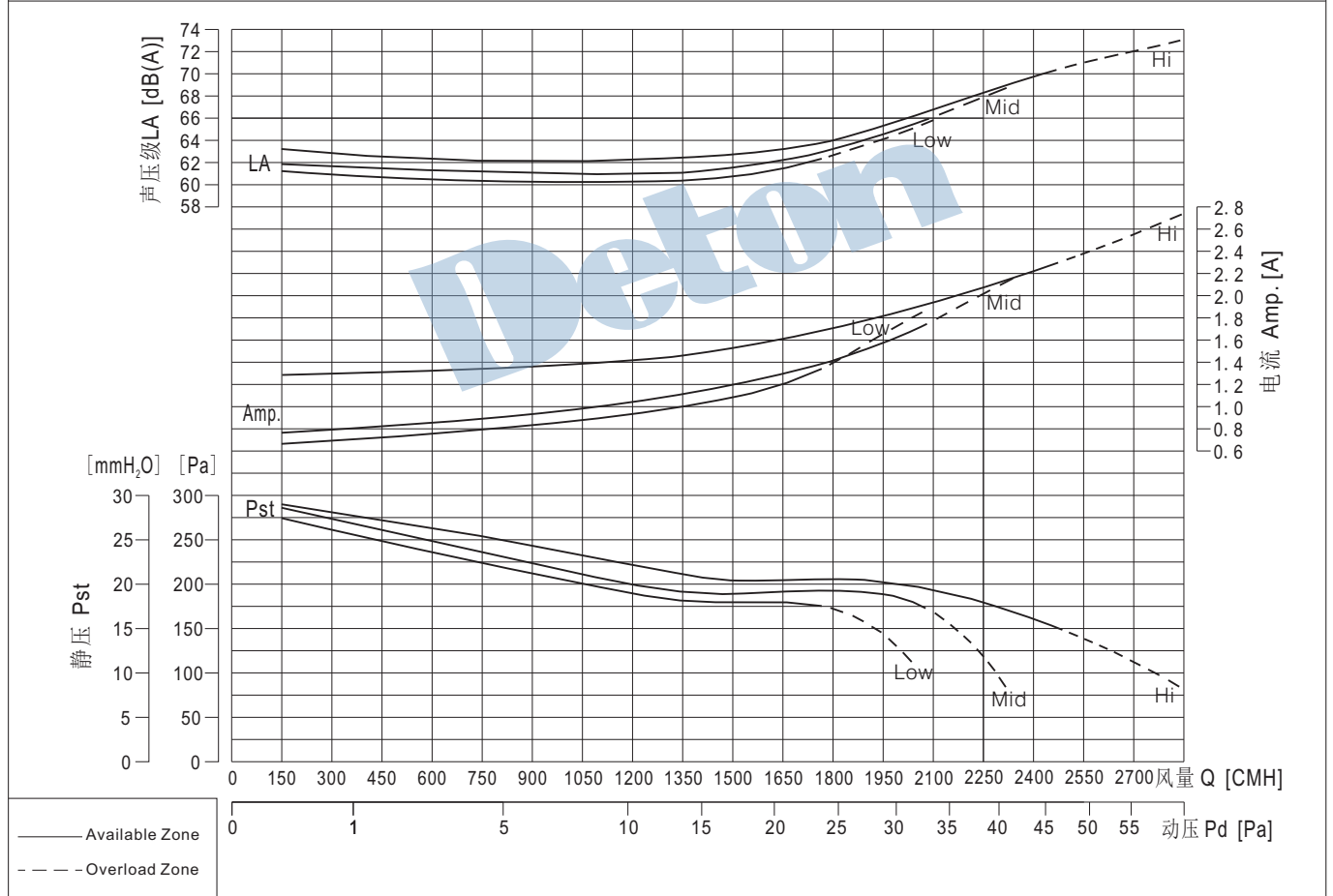



# MTK9-9-S41

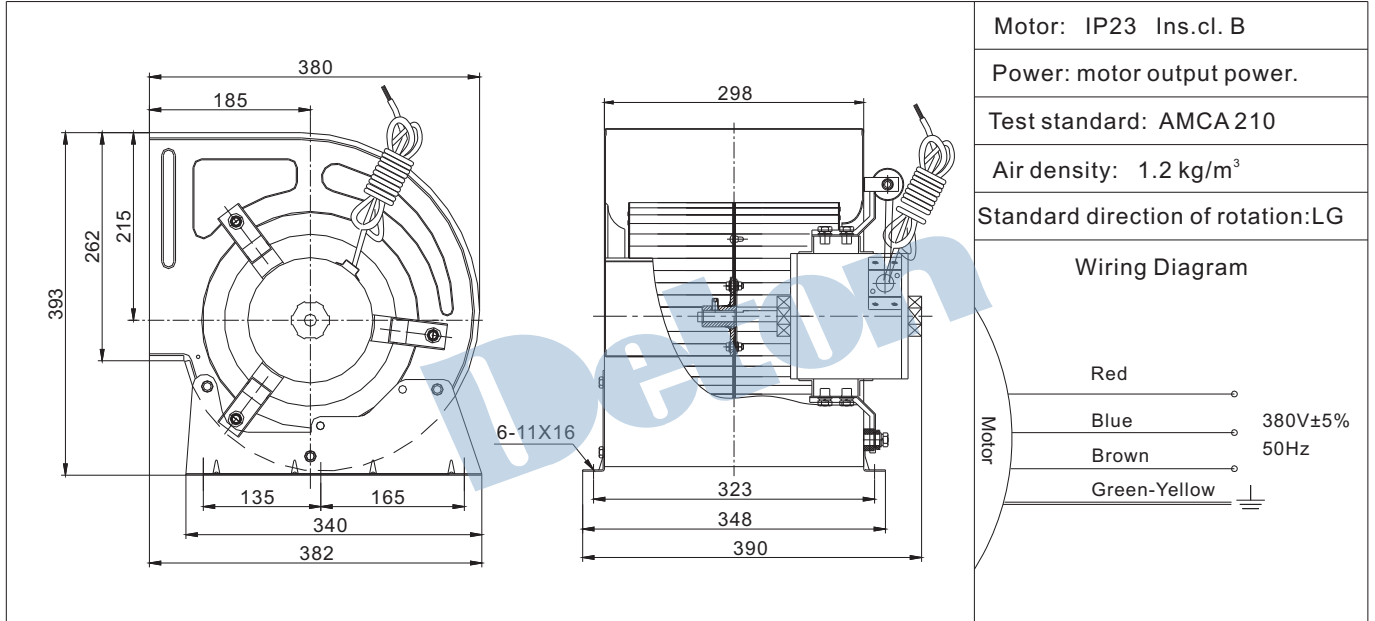

Speed 转速	1330 r/min	Power 功率	550 W	Amp. 电流	2.0 A
-------------	------------	-------------	-------	------------	-------

Voltage 电压	380V±5% / 50Hz	Weight 重量	16.5 kg
---------------	----------------	--------------	---------

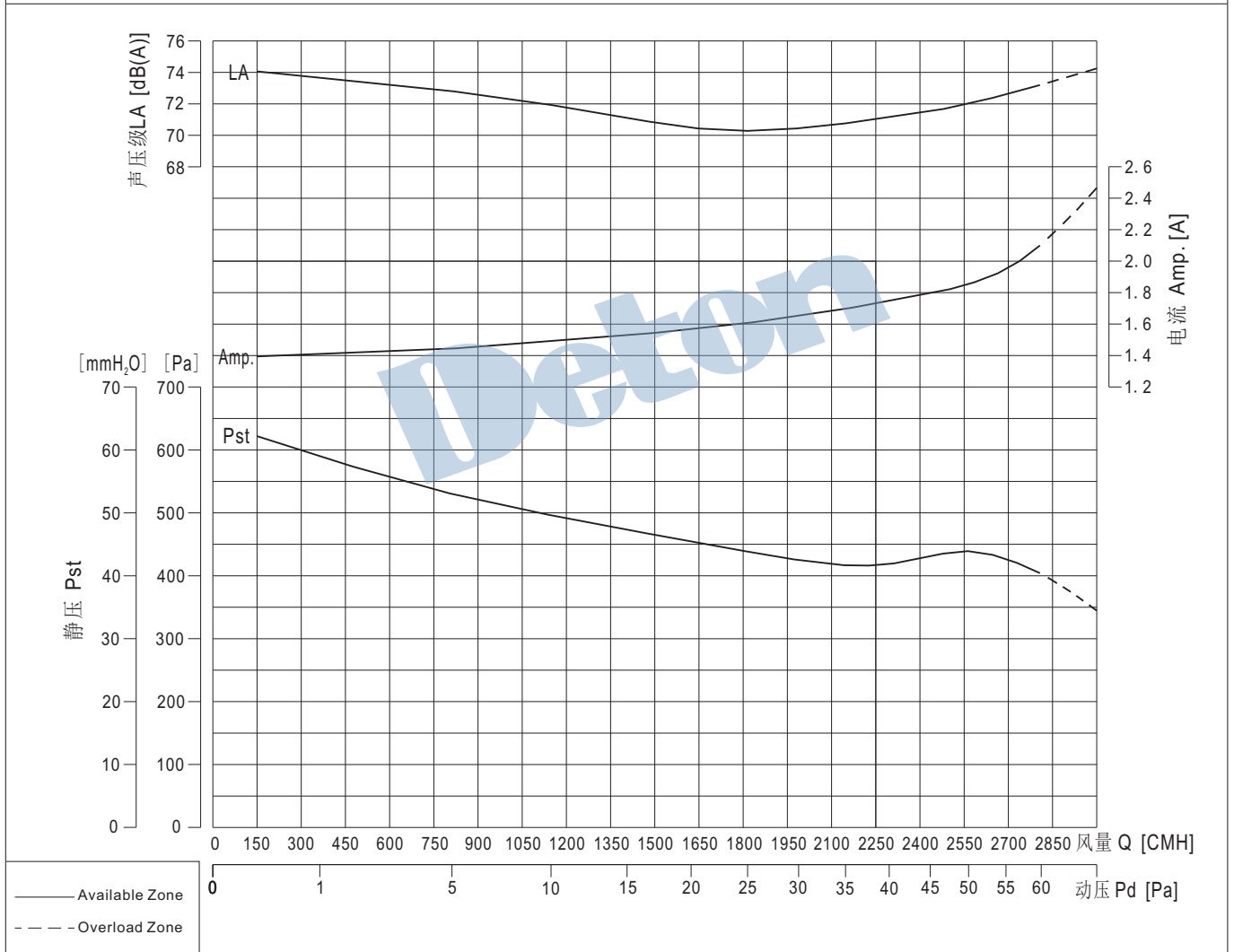

MTK Series

### MTK9-9-S61

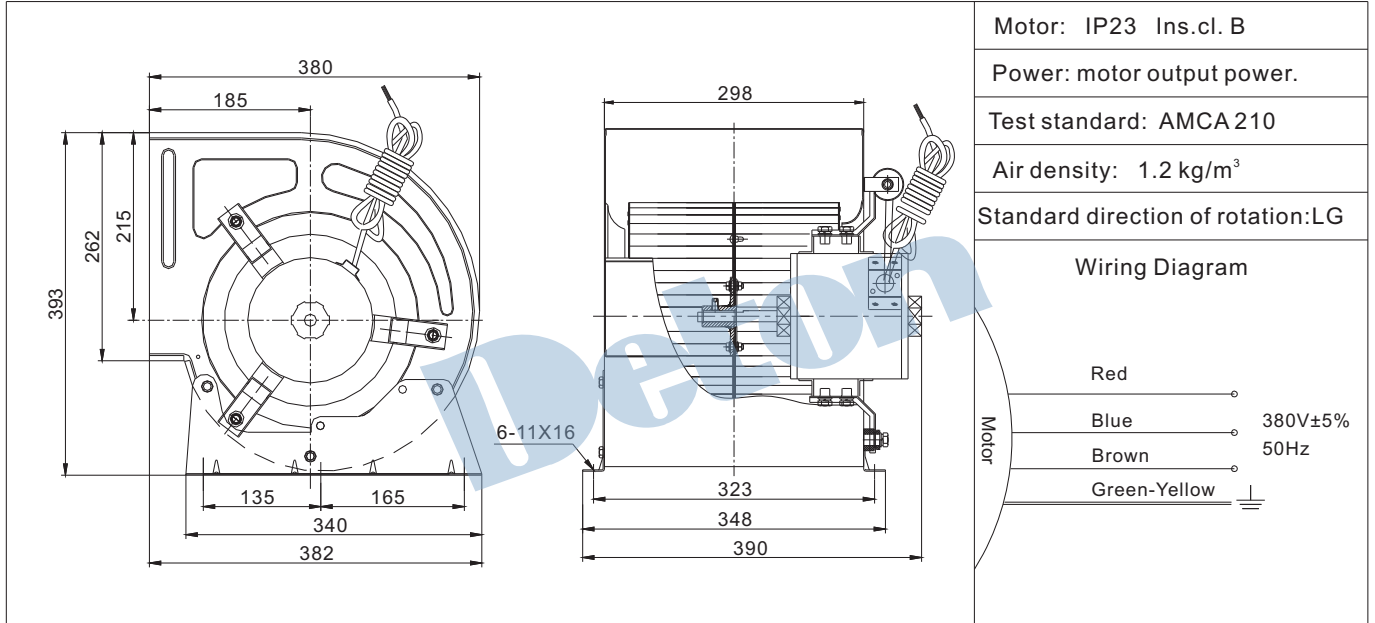

<b>Speed</b> 转速 850 r/min	<b>Power</b> 功率 210 W	<b>Amp.</b> 电流 1.0 A
---------------------------------	-----------------------------	----------------------------

<b>Voltage</b> 电压 380V±5% / 50Hz	<b>Weight</b> 重量 16.5 kg	
--	--------------------------------	--

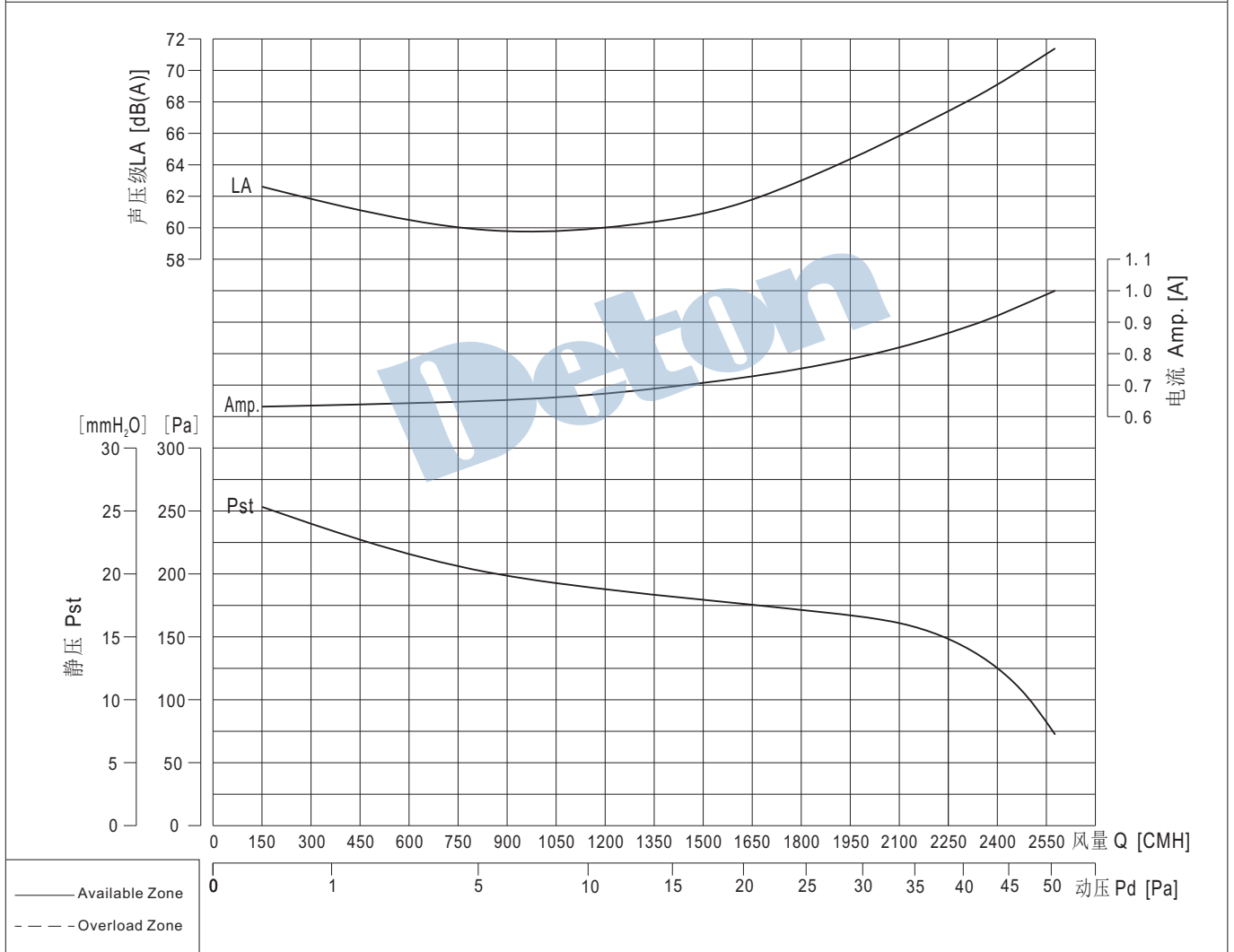

MTK Series

# MTK10-8-D43

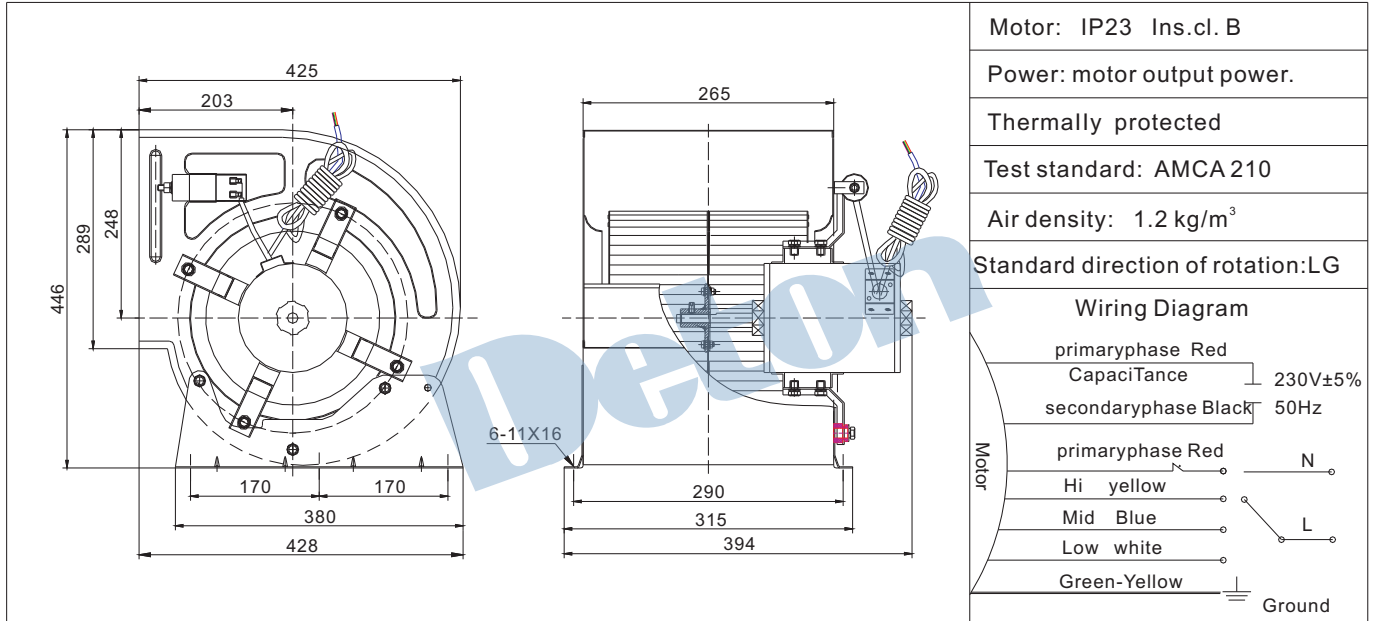

Hi. speed 高速档	Speed 转速	1390 r/min	Power 功率	980 W	Amp. 电流	6.8 A
Mid. speed 中速档	Speed 转速	1280 r/min	Power 功率	780 W	Amp. 电流	5.1 A
Low speed 低速档	Speed 转速	1200 r/min	Power 功率	700 W	Amp. 电流	4.6 A

Capacitor 电容	33 $\mu$ F / 450V	Voltage 电压	230V $\pm$ 5% / 50Hz	Weight 重量	20.5 kg
-----------------	-------------------	---------------	----------------------	--------------	---------

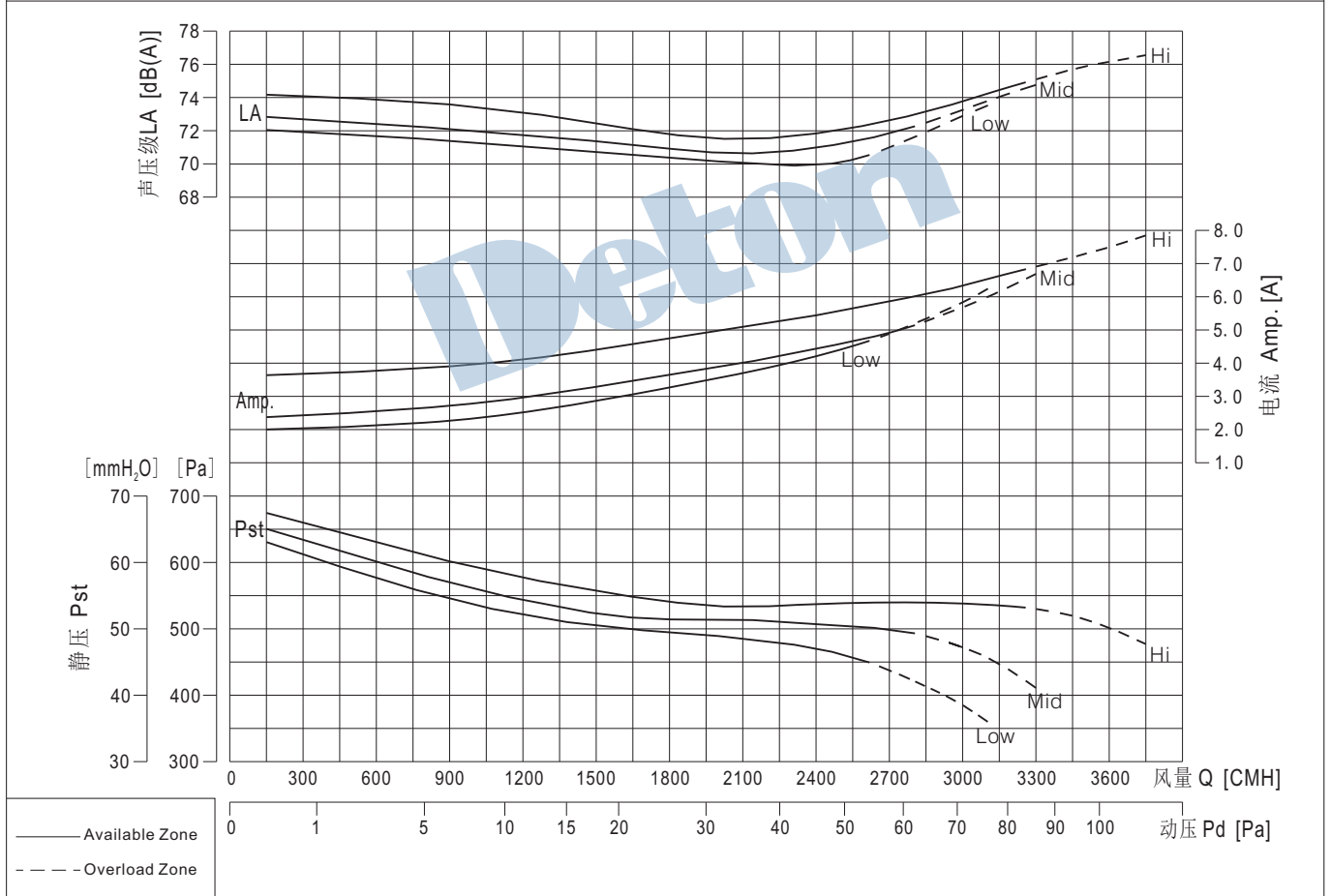

### MTK10-8-D63

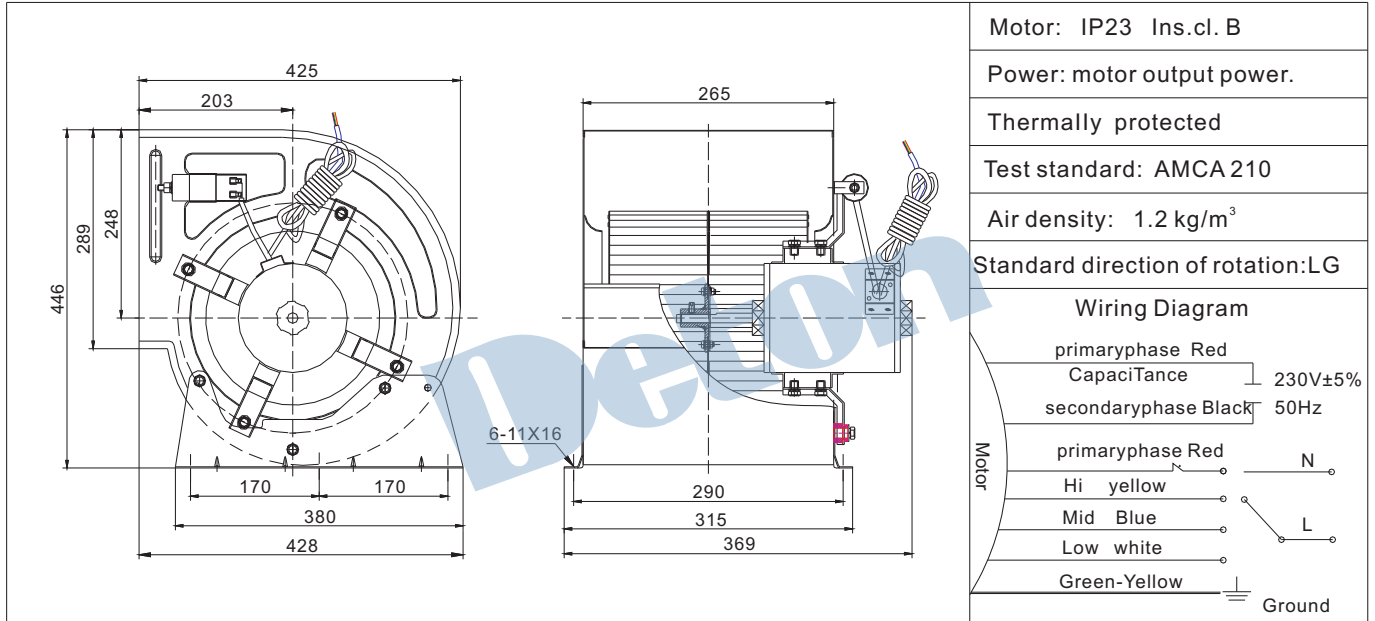

Hi. speed 高速档	Speed 转速	880 r/min	Power 功率	400 W	Amp. 电流	2.6 A	
Mid. speed 中速档	Speed 转速	830 r/min	Power 功率	280 W	Amp. 电流	1.9 A	
Low speed 低速档	Speed 转速	750 r/min	Power 功率	210 W	Amp. 电流	1.6 A	
Capacitor 电容		12 $\mu$ F / 450V	Voltage 电压		230V $\pm$ 5% / 50Hz	Weight 重量	16.5 kg

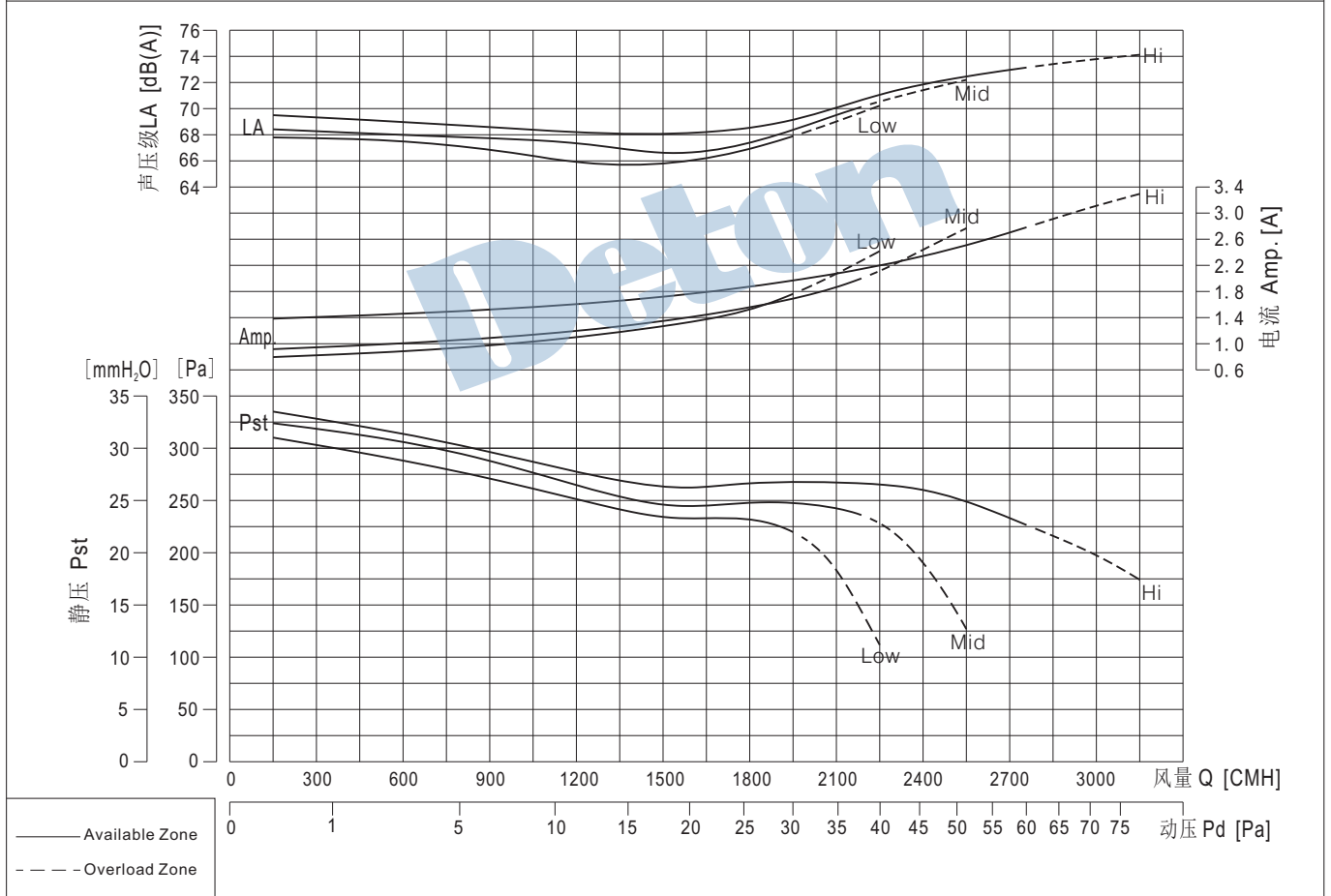

MTK Series

# MTK10-8-S41

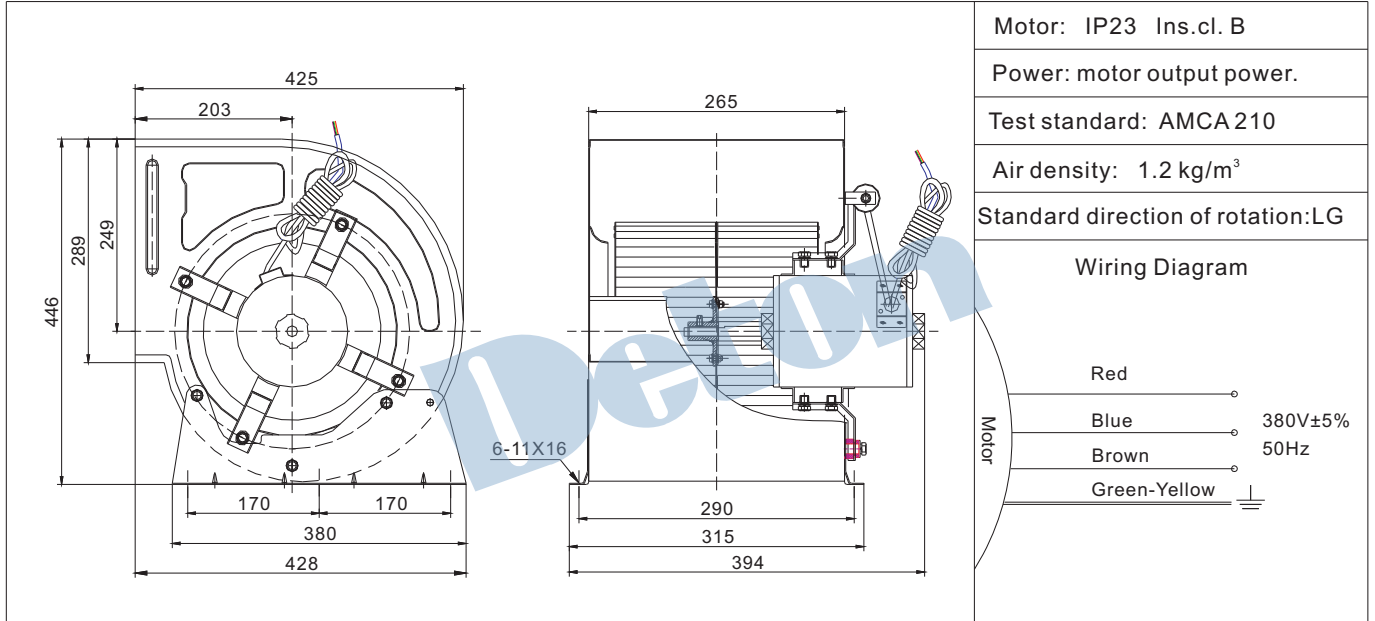

Speed 转速	1330 r/min	Power 功率	1080 W	Amp. 电流	3.1A
-------------	------------	-------------	--------	------------	------

Voltage 电压	380V±5% / 50Hz	Weight 重量	20.5 kg
---------------	----------------	--------------	---------

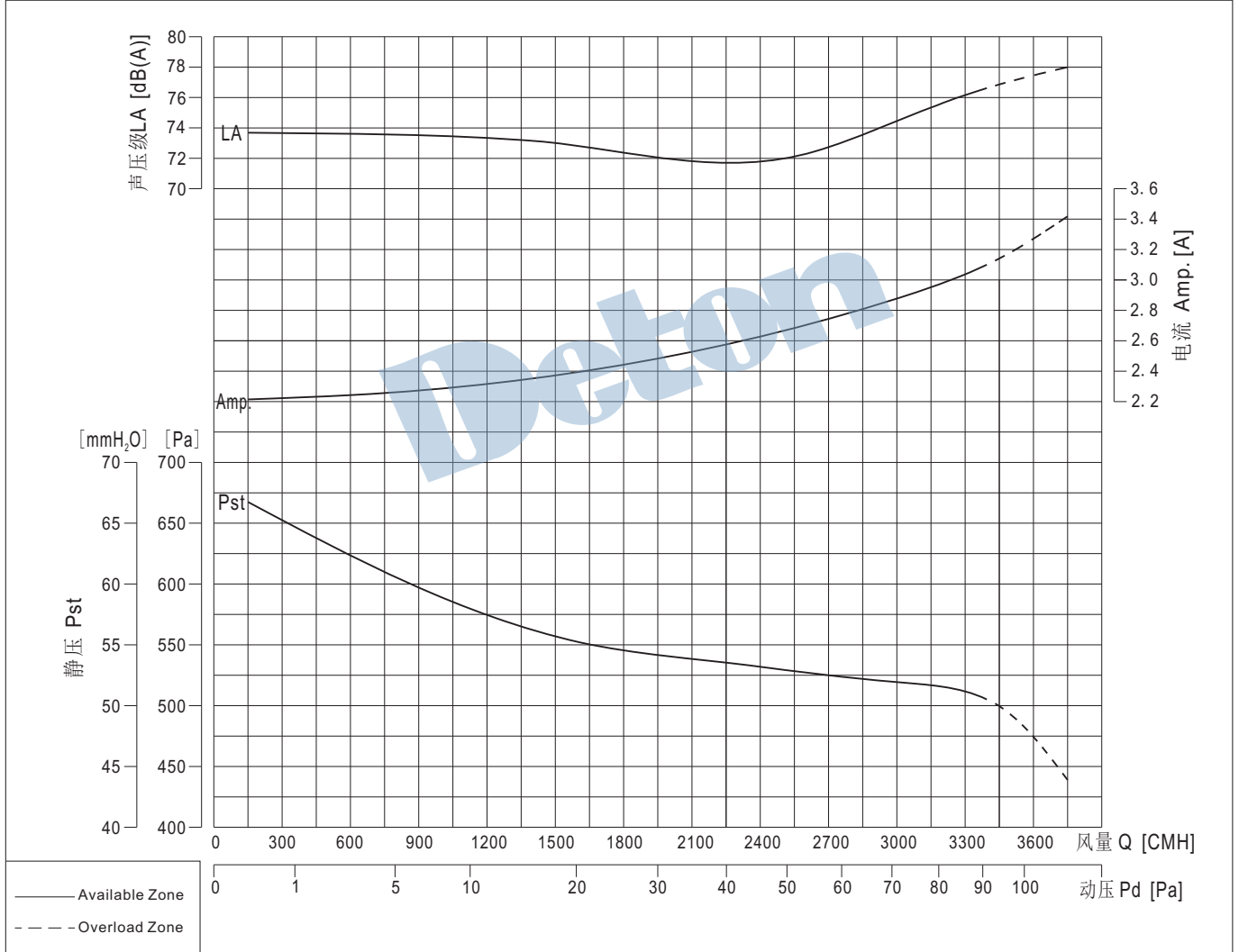

MTK Series

# MTK10-8-S61

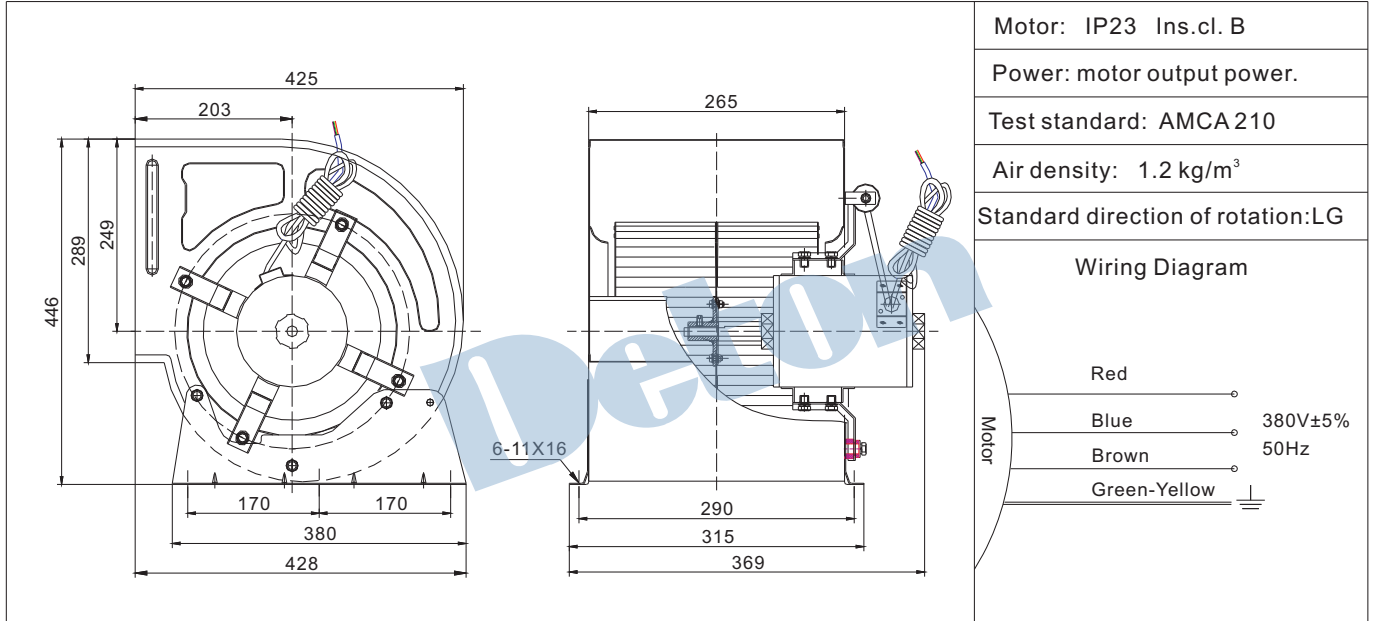

Speed 转速	890 r/min	Power 功率	450 W	Amp. 电流	1.9 A
-------------	-----------	-------------	-------	------------	-------

Voltage 电压	380V±5% / 50Hz	Weight 重量	16.5 kg
---------------	----------------	--------------	---------

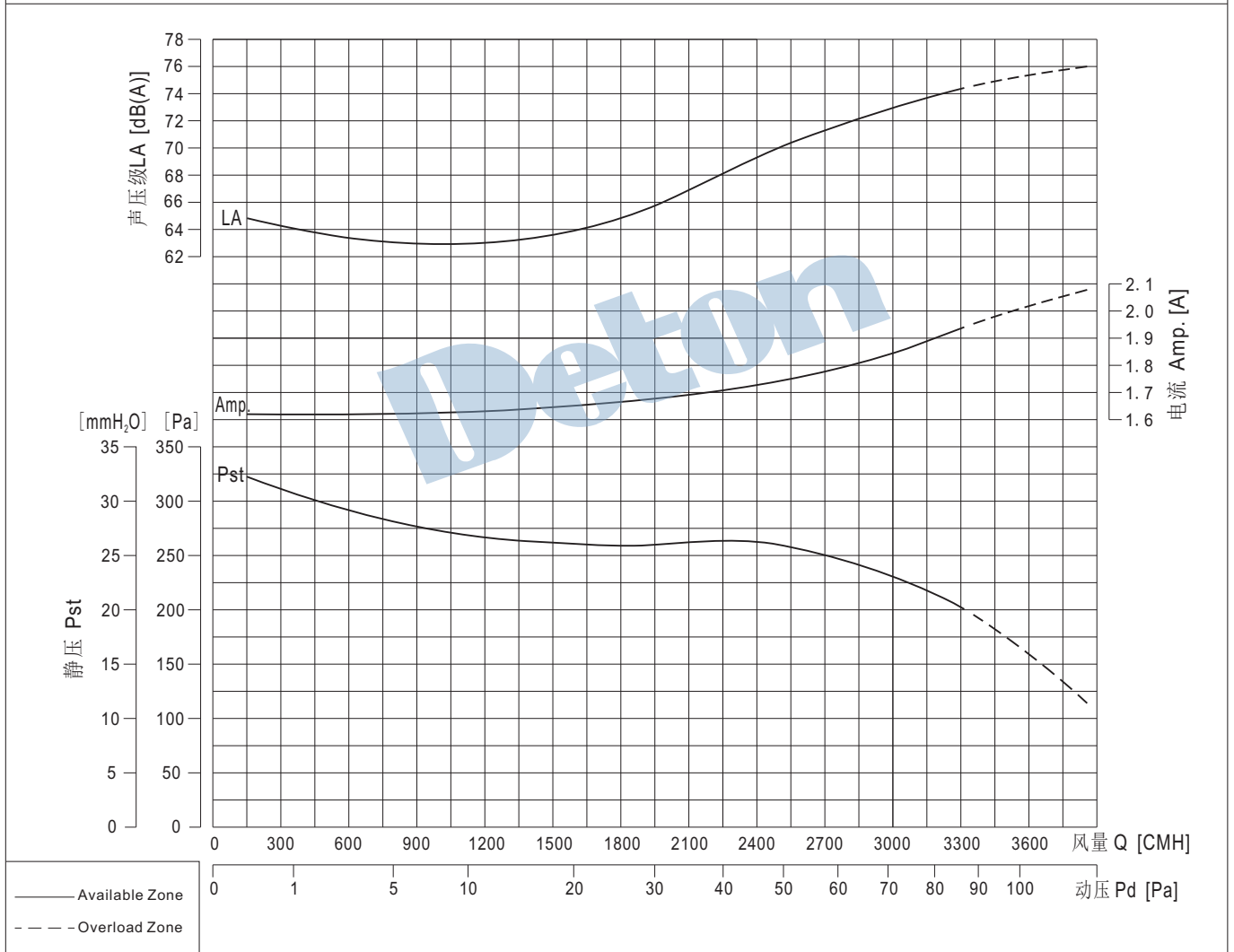

# MTK10-10-D43

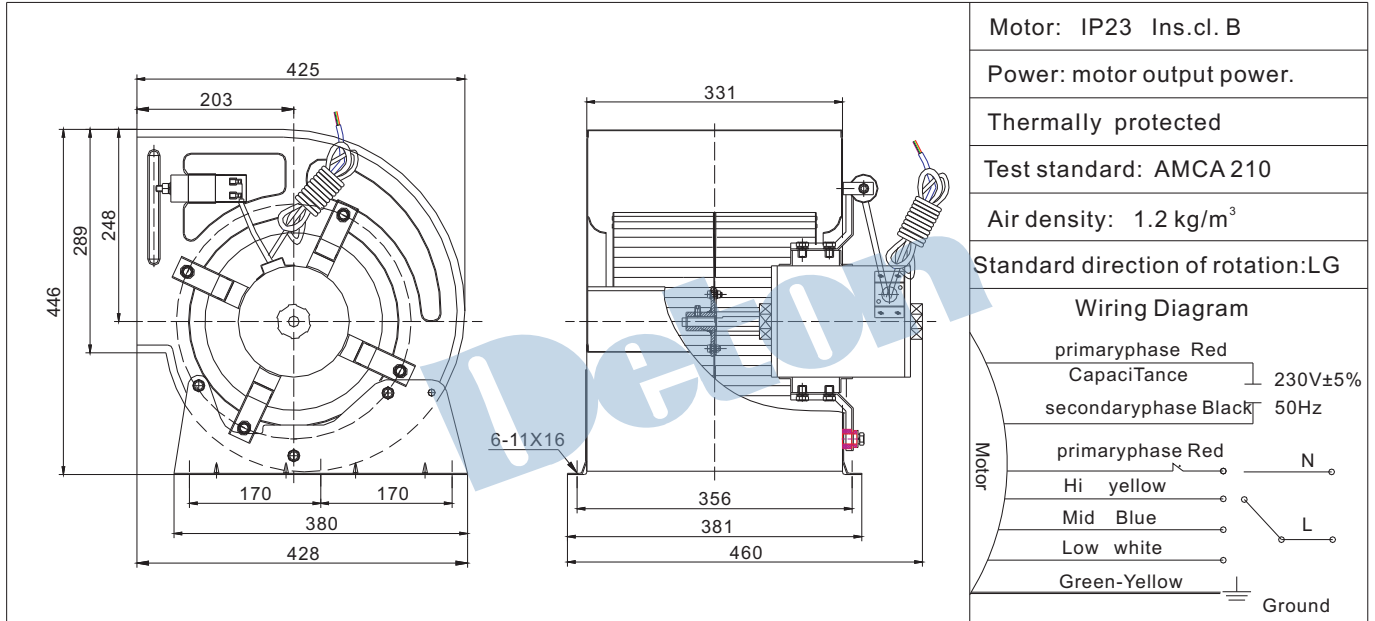

Motor: IP23 Ins.cl. B  
 Power: motor output power.  
 Thermally protected  
 Test standard: AMCA 210  
 Air density: 1.2 kg/m<sup>3</sup>  
 Standard direction of rotation: LG

**Wiring Diagram**

primaryphase Red  
 Capacitance 230V±5%  
 secondaryphase Black 50Hz

Motor

primaryphase Red N  
 Hi yellow L  
 Mid Blue  
 Low white  
 Green-Yellow Ground

Hi. speed 高速档	Speed 转速	1380 r/min	Power 功率	1100 W	Amp. 电流	7.2 A
Mid. speed 中速档	Speed 转速	1260 r/min	Power 功率	850 W	Amp. 电流	5.5 A
Low speed 低速档	Speed 转速	1180 r/min	Power 功率	780 W	Amp. 电流	5.2 A
Capacitor 电容		33μF / 450V		Voltage 电压	230V±5% / 50Hz	
				Weight 重量	22.5 kg	

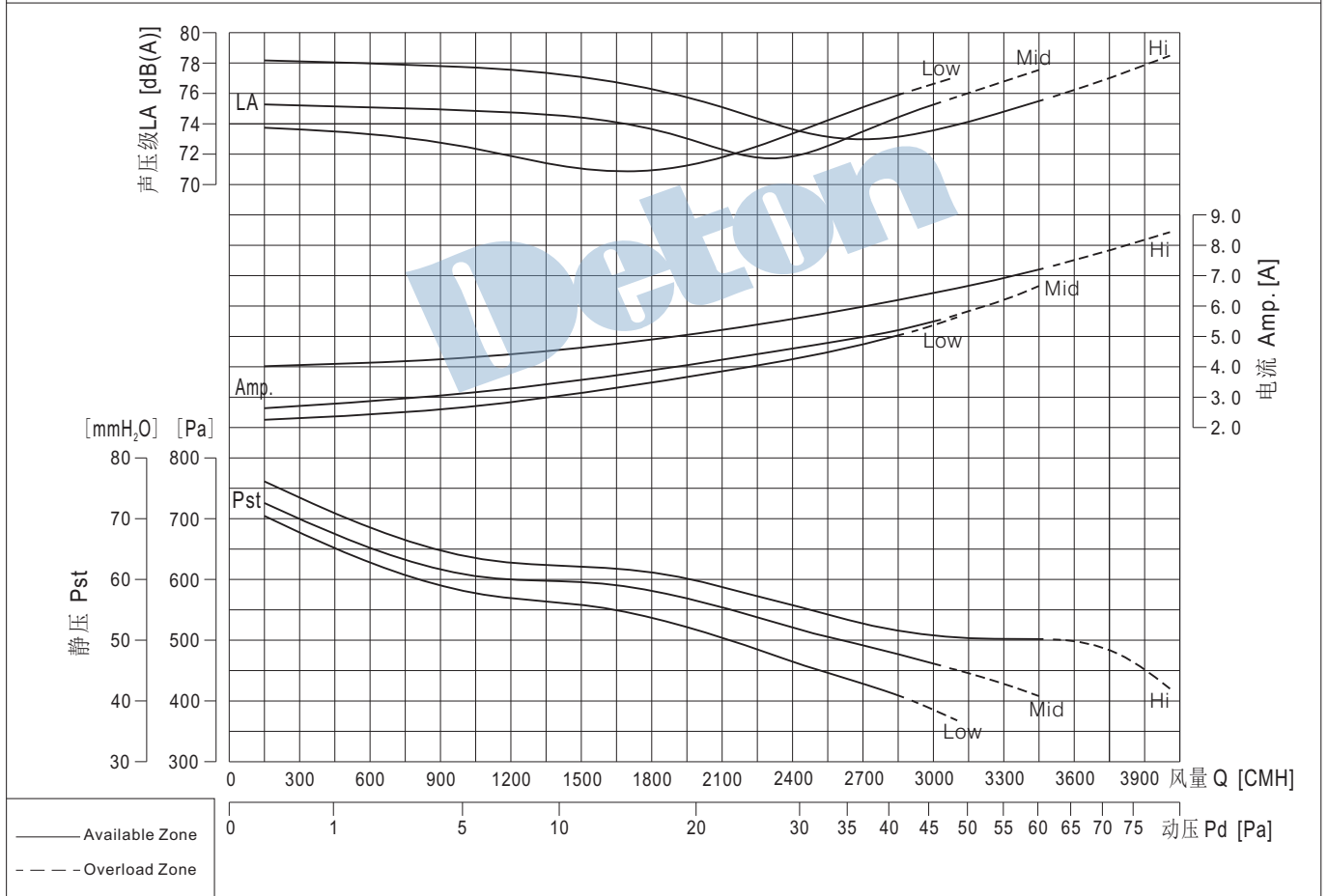

MTK Series

## MTK10-10-D63

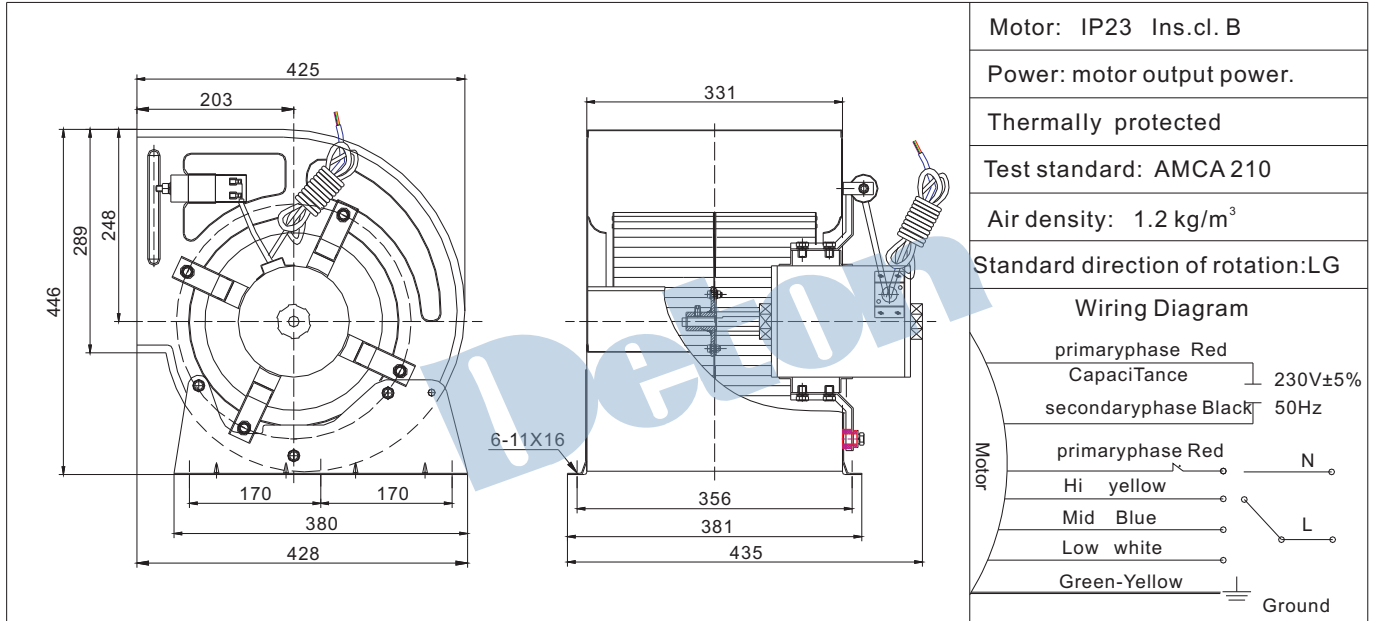

Hi. speed 高速档	Speed 转速	890 r/min	Power 功率	450 W	Amp. 电流	3.0 A	
Mid. speed 中速档	Speed 转速	820 r/min	Power 功率	330 W	Amp. 电流	2.0 A	
Low speed 低速档	Speed 转速	740 r/min	Power 功率	250 W	Amp. 电流	1.7 A	
Capacitor 电容		16μF /450V	Voltage 电压		230V±5% / 50Hz	Weight 重量	20 kg

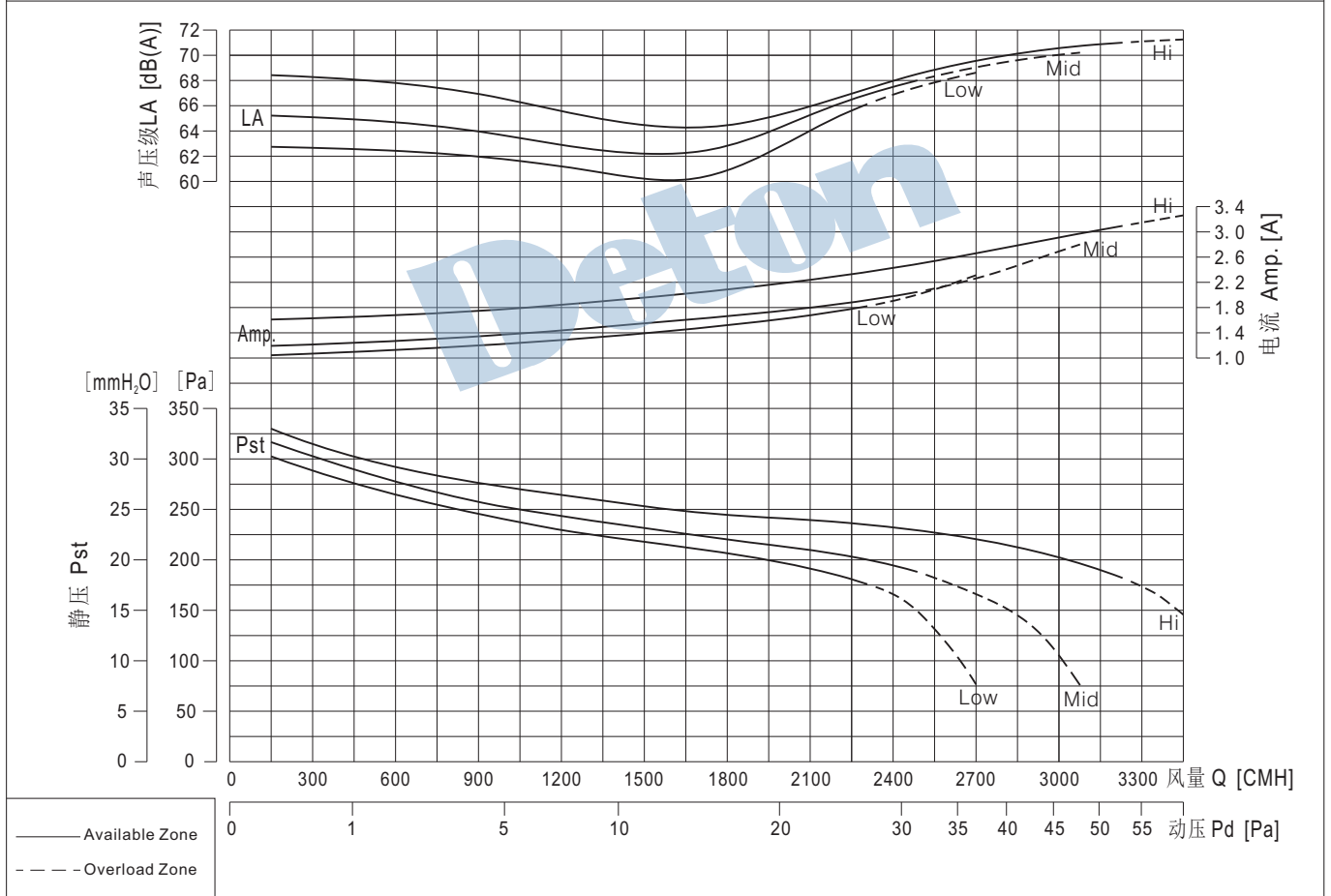



# MTK10-10-S41

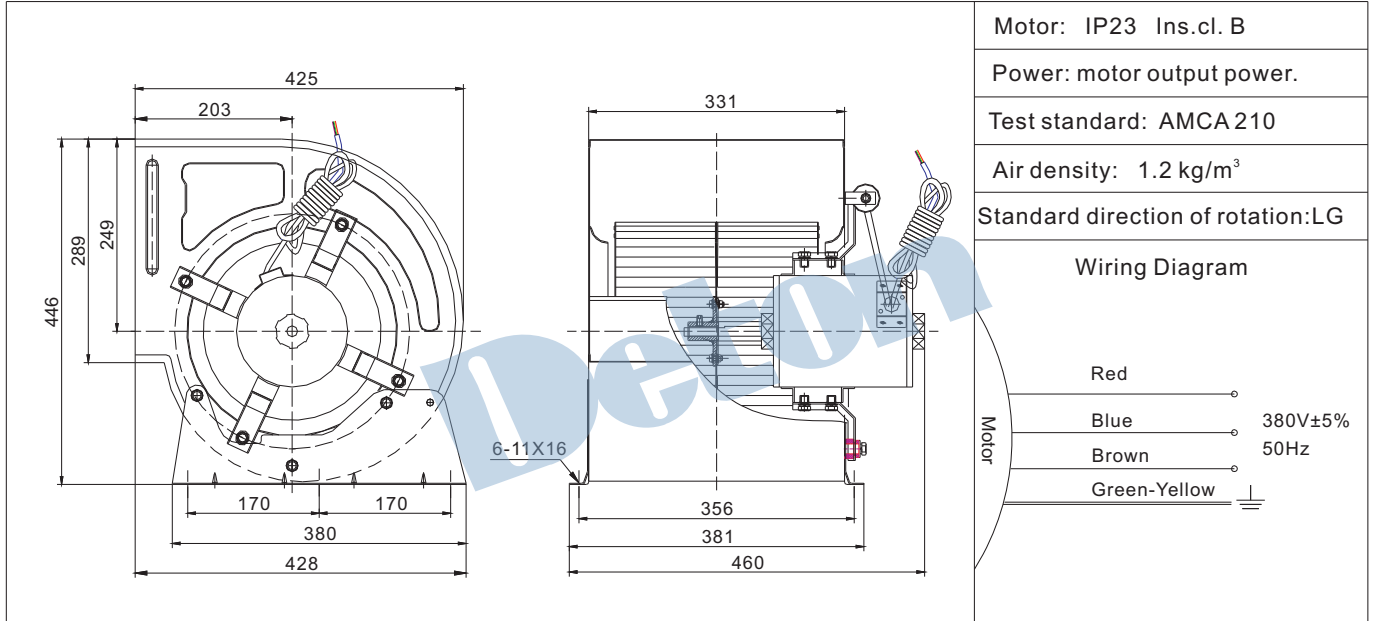

Speed 转速	1360 r/min	Power 功率	1150 W	Amp. 电流	3.2 A
-------------	------------	-------------	--------	------------	-------

Voltage 电压	380V±5% / 50Hz	Weight 重量	22.5 kg
---------------	----------------	--------------	---------

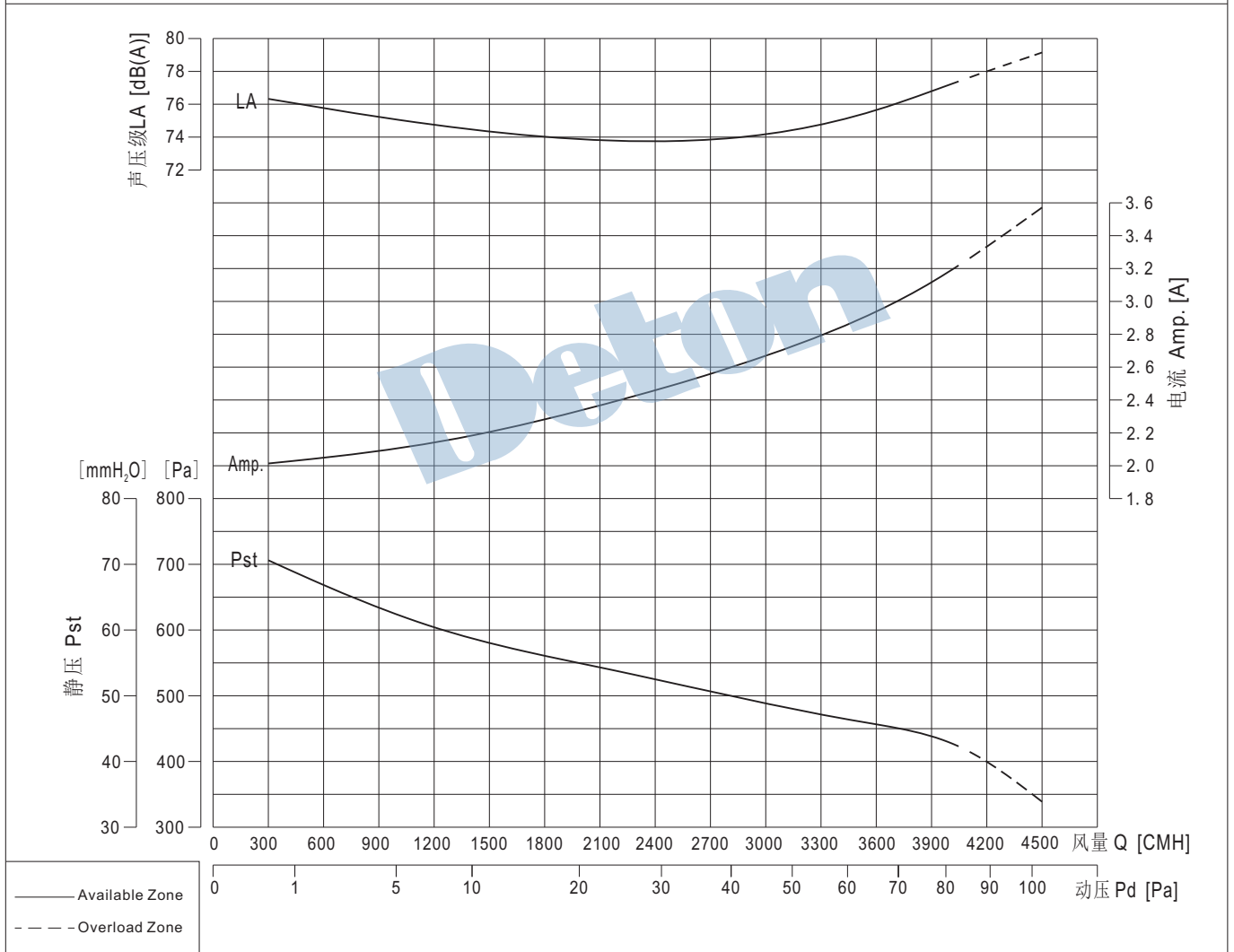

### MTK10-10-S61

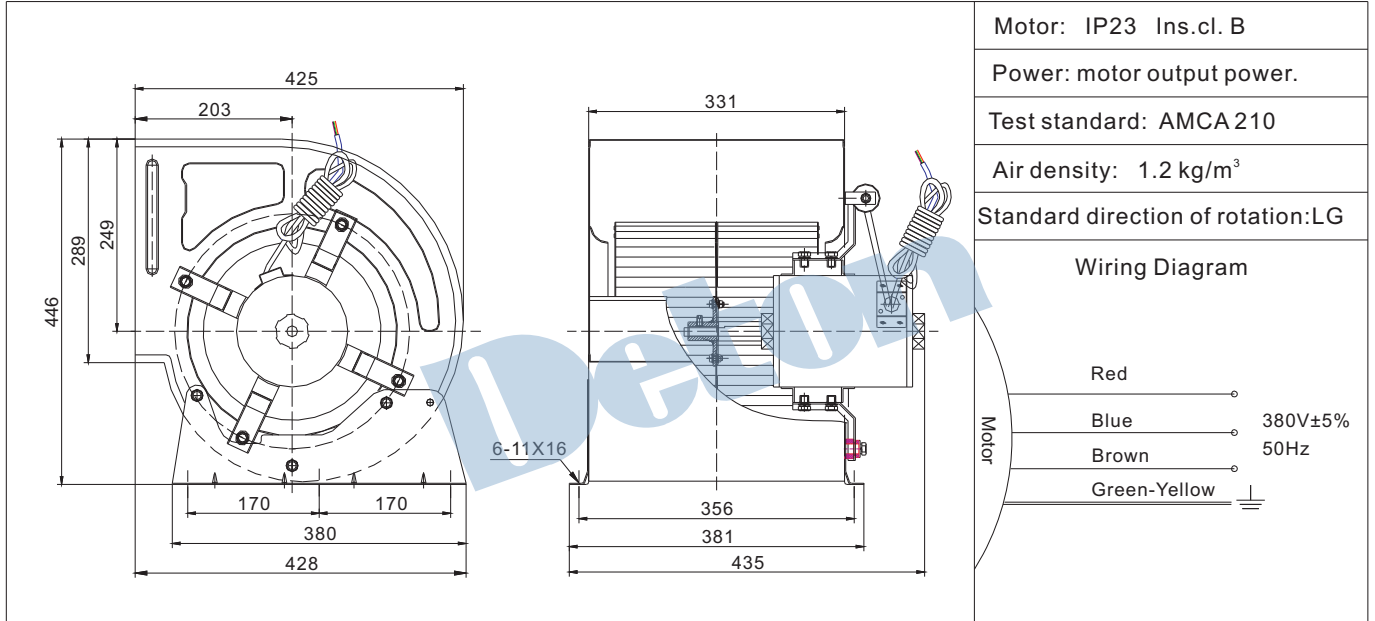

Speed 转速	880 r/min	Power 功率	500 W	Amp. 电流	2.1 A
-------------	-----------	-------------	-------	------------	-------

Voltage 电压	380V±5% / 50Hz	Weight 重量	20 kg
---------------	----------------	--------------	-------

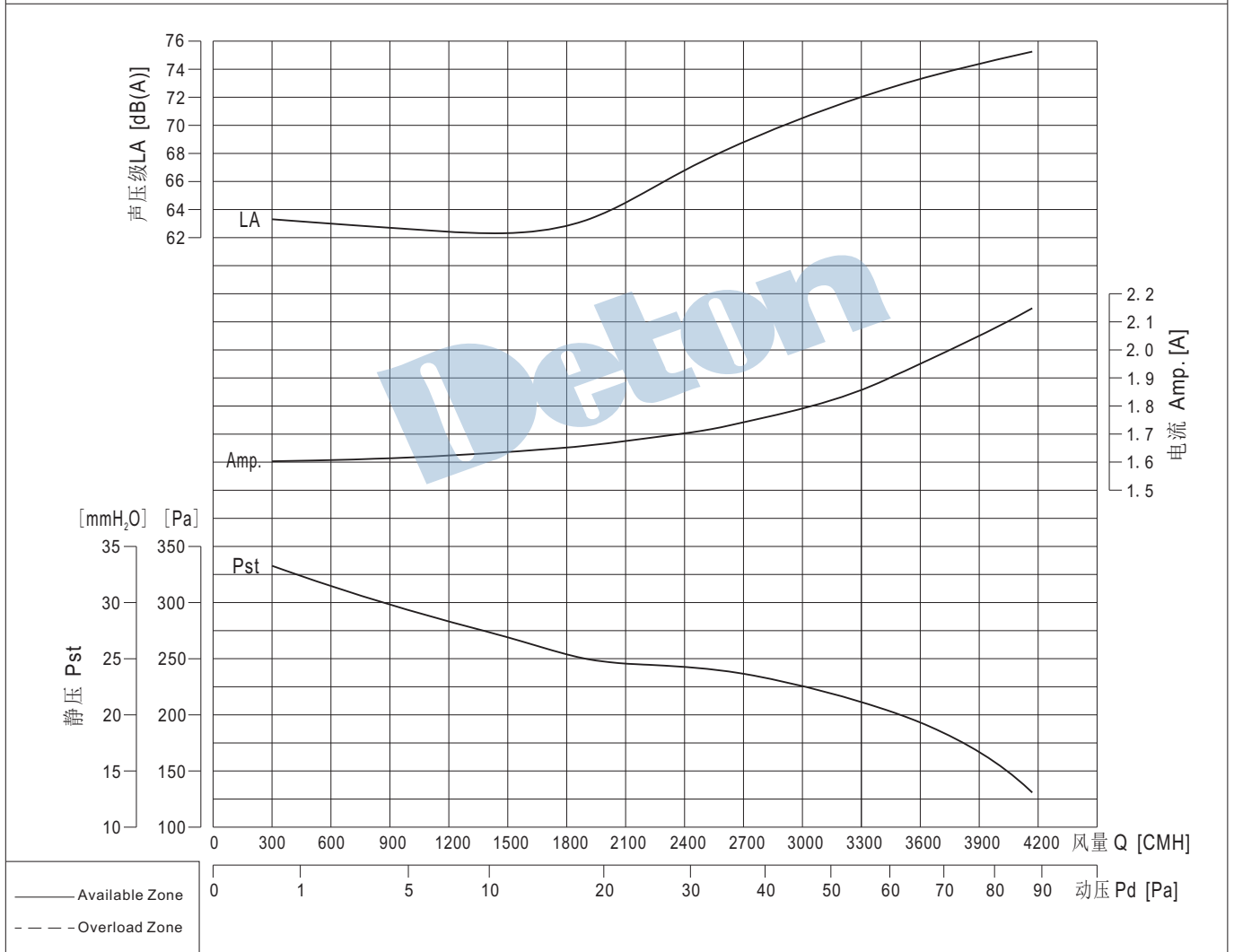

# MTK12-9-D63

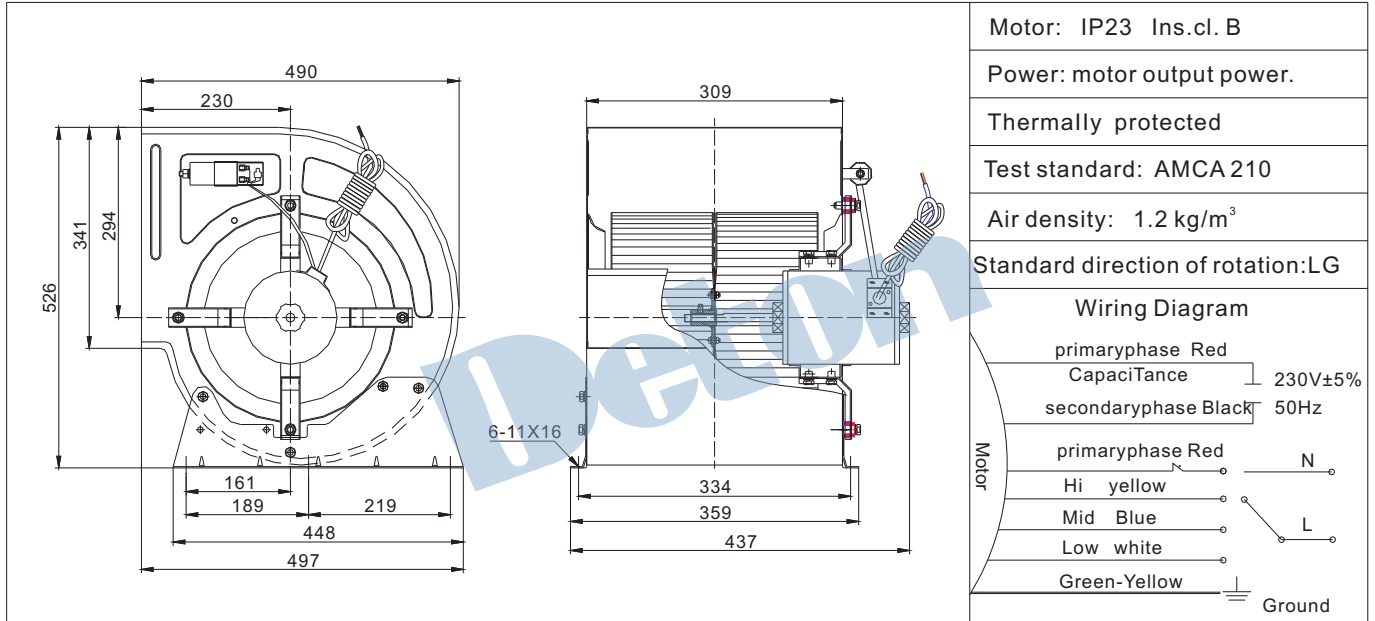

Hi. speed 高速档	Speed 转速	900 r/min	Power 功率	700 W	Amp. 电流	5.5 A
Mid. speed 中速档	Speed 转速	840 r/min	Power 功率	450 W	Amp. 电流	3.9 A
Low speed 低速档	Speed 转速	780 r/min	Power 功率	400 W	Amp. 电流	3.4 A

Capacitor 电容	22 $\mu$ F / 450V	Voltage 电压	230V $\pm$ 5% / 50Hz	Weight 重量	26.5 kg
-----------------	-------------------	---------------	----------------------	--------------	---------

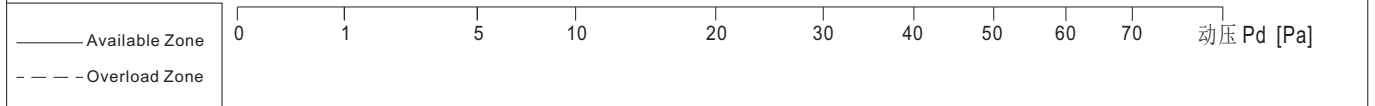
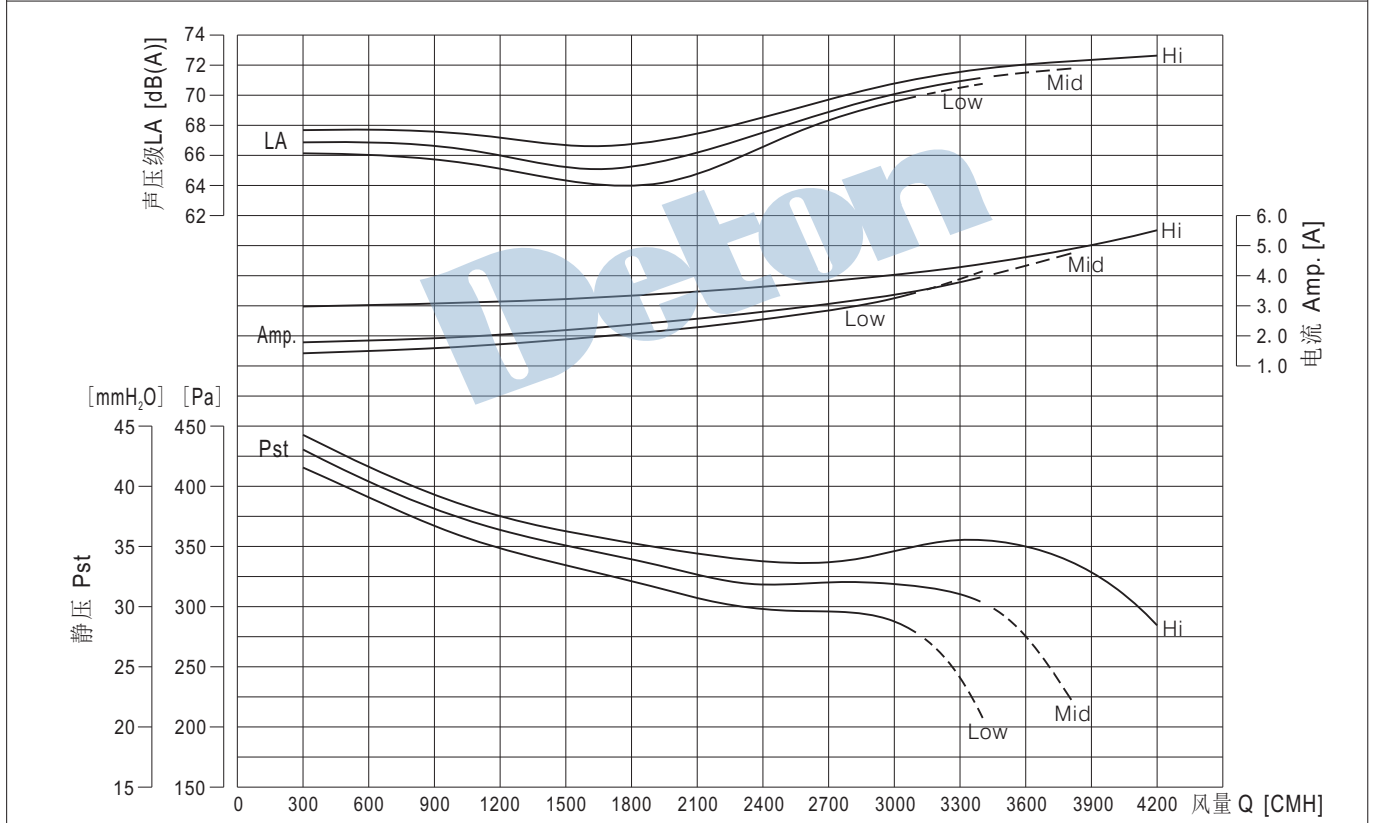

MTK Series

### MTK12-9-S61

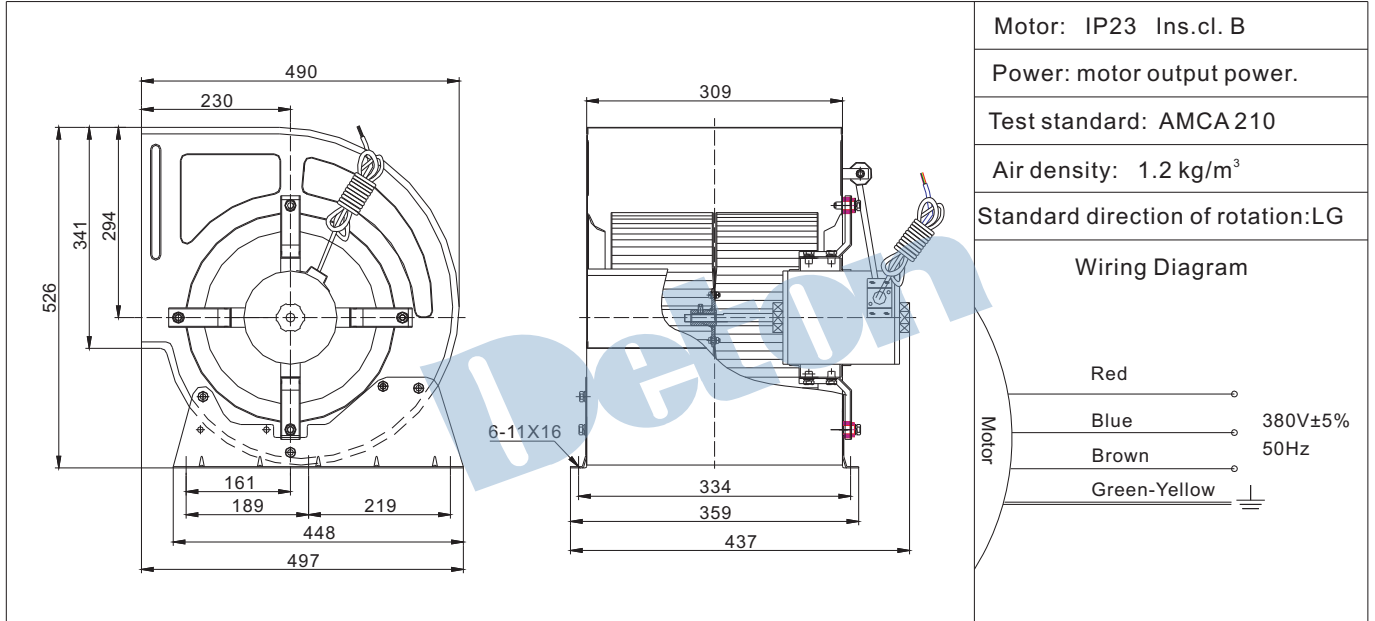

Speed 转速	890 r/min	Power 功率	780 W	Amp. 电流	2.7A
-------------	-----------	-------------	-------	------------	------

Voltage 电压	380V±5% / 50Hz	Weight 重量	25.5 kg
---------------	----------------	--------------	---------

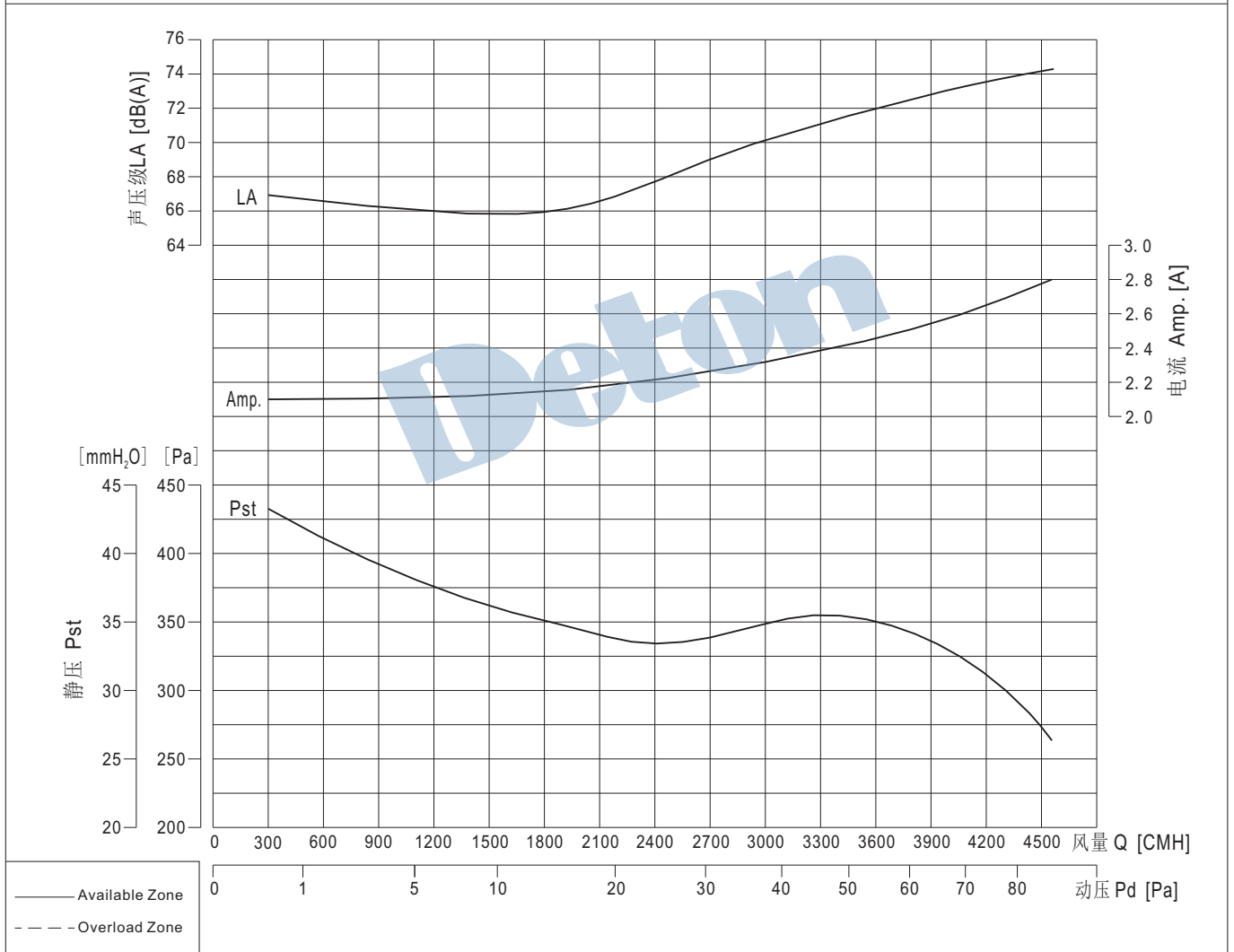

# MTK12-12-D63

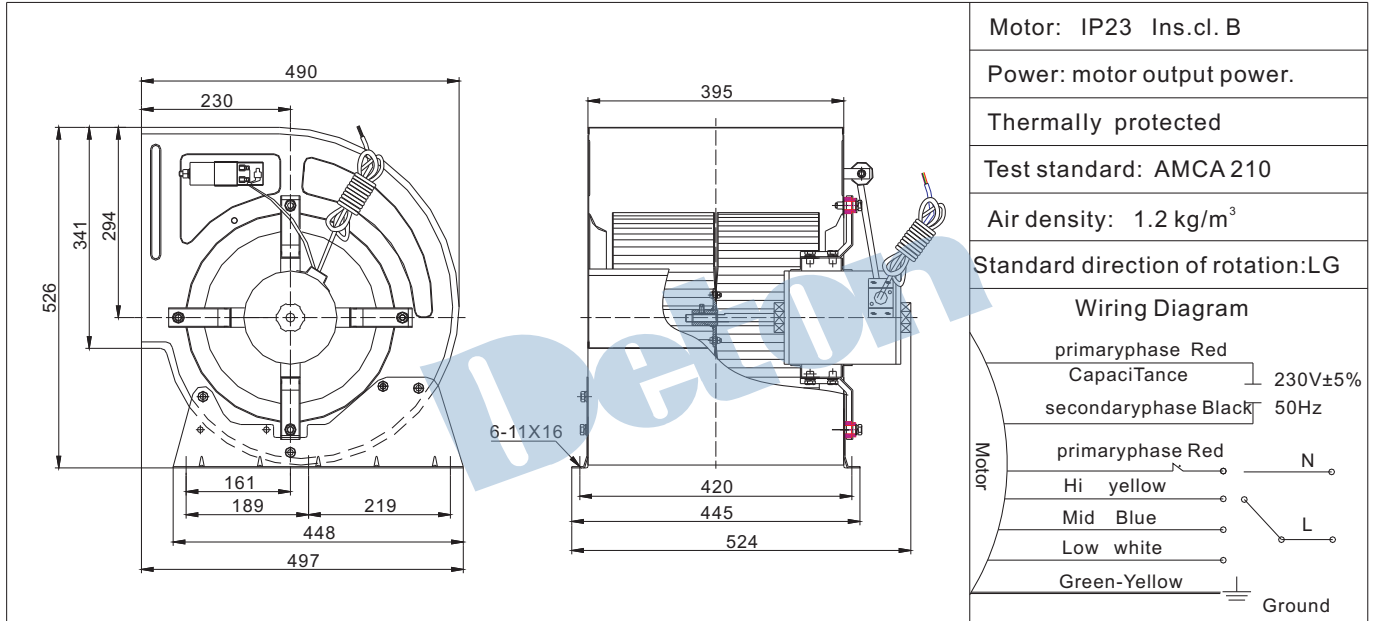

Hi. speed 高速档	Speed 转速	890 r/min	Power 功率	750 W	Amp. 电流	5.8 A
Mid. speed 中速档	Speed 转速	820 r/min	Power 功率	500 W	Amp. 电流	4.8 A
Low speed 低速档	Speed 转速	760 r/min	Power 功率	420 W	Amp. 电流	3.5 A

Capacitor 电容	24 $\mu$ F / 450V	Voltage 电压	230V $\pm$ 5% / 50Hz	Weight 重量	28.5 kg
-----------------	-------------------	---------------	----------------------	--------------	---------

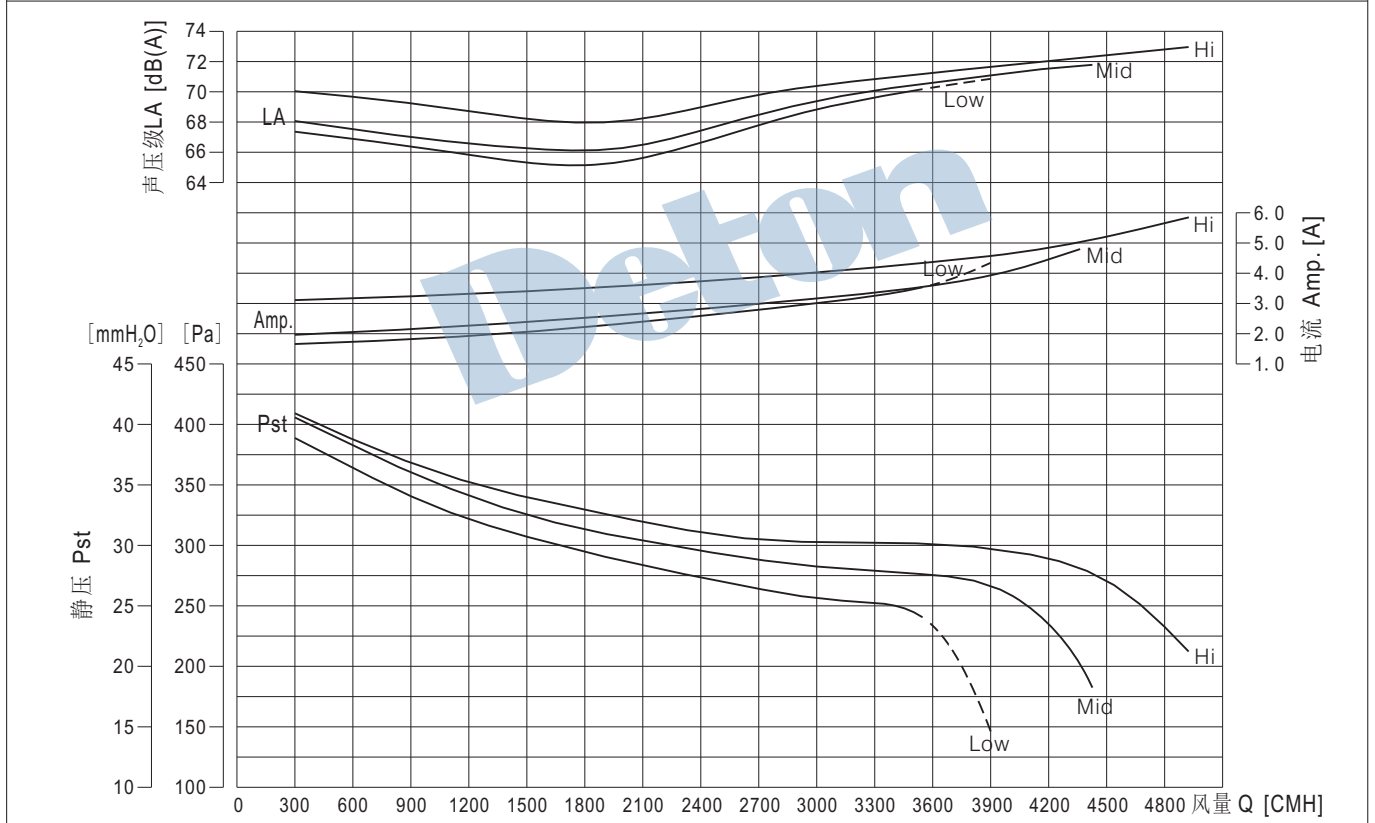

MTK Series

### MTK12-12-S61

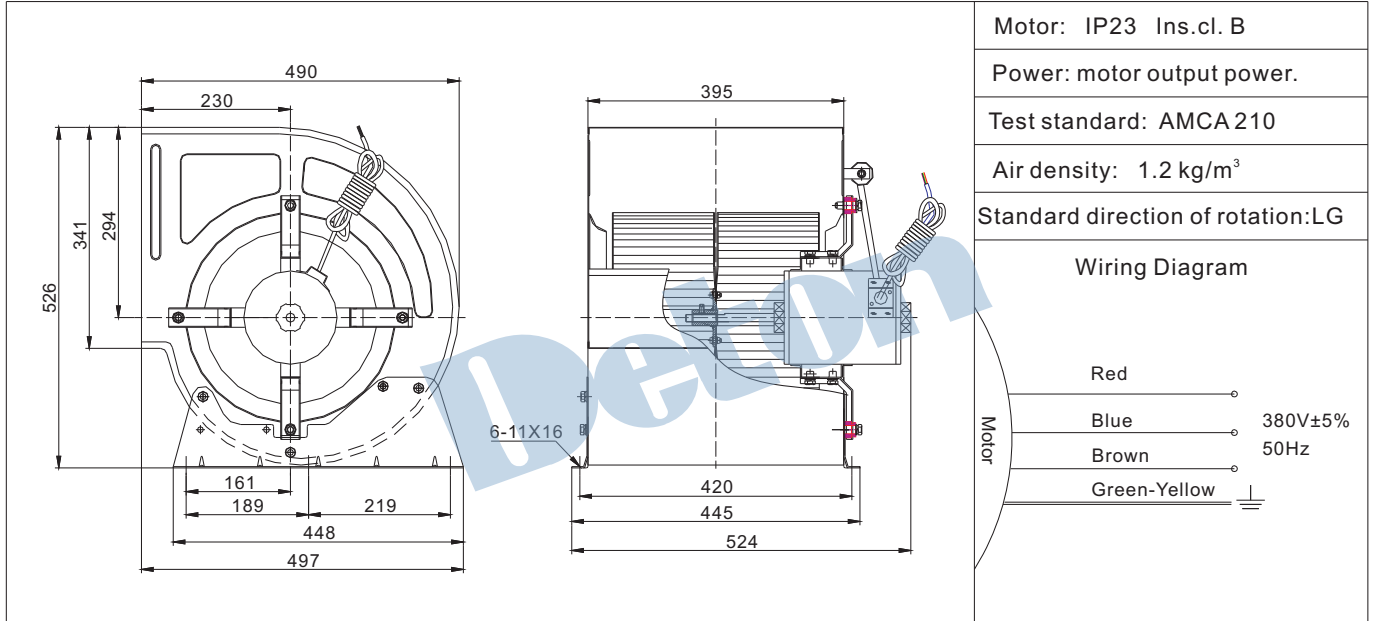

Speed 转速	880 r/min	Power 功率	850 W	Amp. 电流	3.0 A
-------------	-----------	-------------	-------	------------	-------

Voltage 电压	380V±5% / 50Hz	Weight 重量	27.5 kg
---------------	----------------	--------------	---------

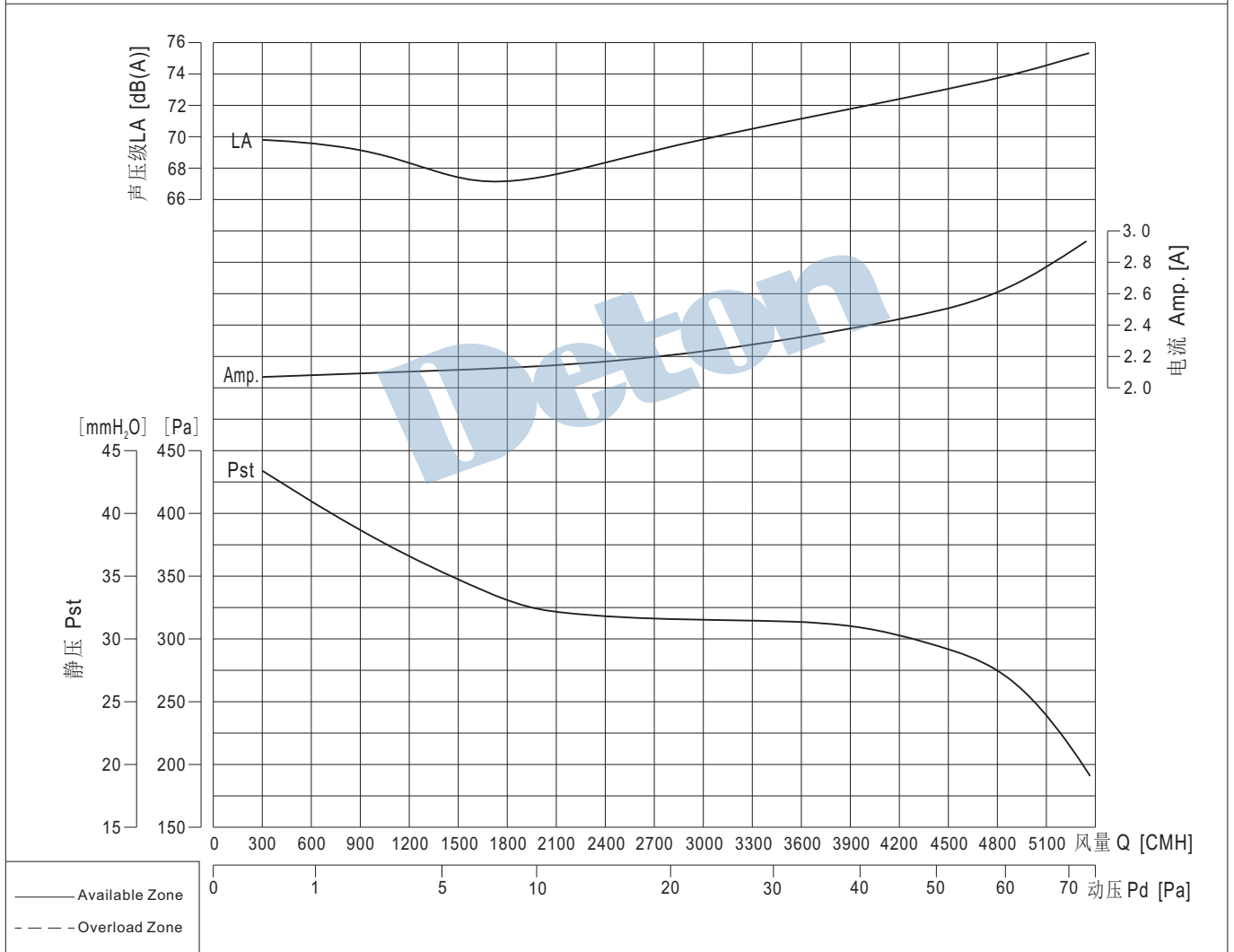

MTK Series